

Civil Design Documentation

Proposed Subdivision

Lots 9 & 10 in DP 1233495

13 Fairydale Lane, Mudgee NSW 2850

SCHEDULE OF DRAWINGS

SHEET No.	DESCRIPTION
37880-C00	COVER SHEET AND DRAWING SCHEDULE
37880-C01	EXISTING SITE PLAN
37880-C02	PROPOSED SITE PLAN
37880-C03	PROPOSED LOT PLAN
37880-C04	PROPOSED BULK EARTHWORKS PLAN
37880-C05	PROPOSED BULK EARTHWORKS SPECIFICATIONS
37880-C06	PROPOSED STORMWATER PLAN
37880-C07	PROPOSED FLOOD IMPACT PLAN
37880-C08	PROPOSED SEWER PLAN
37880-C09	PROPOSED SEWER LONGSECTIONS AND DETAILS
37880-C10	PROPOSED WATER PLAN

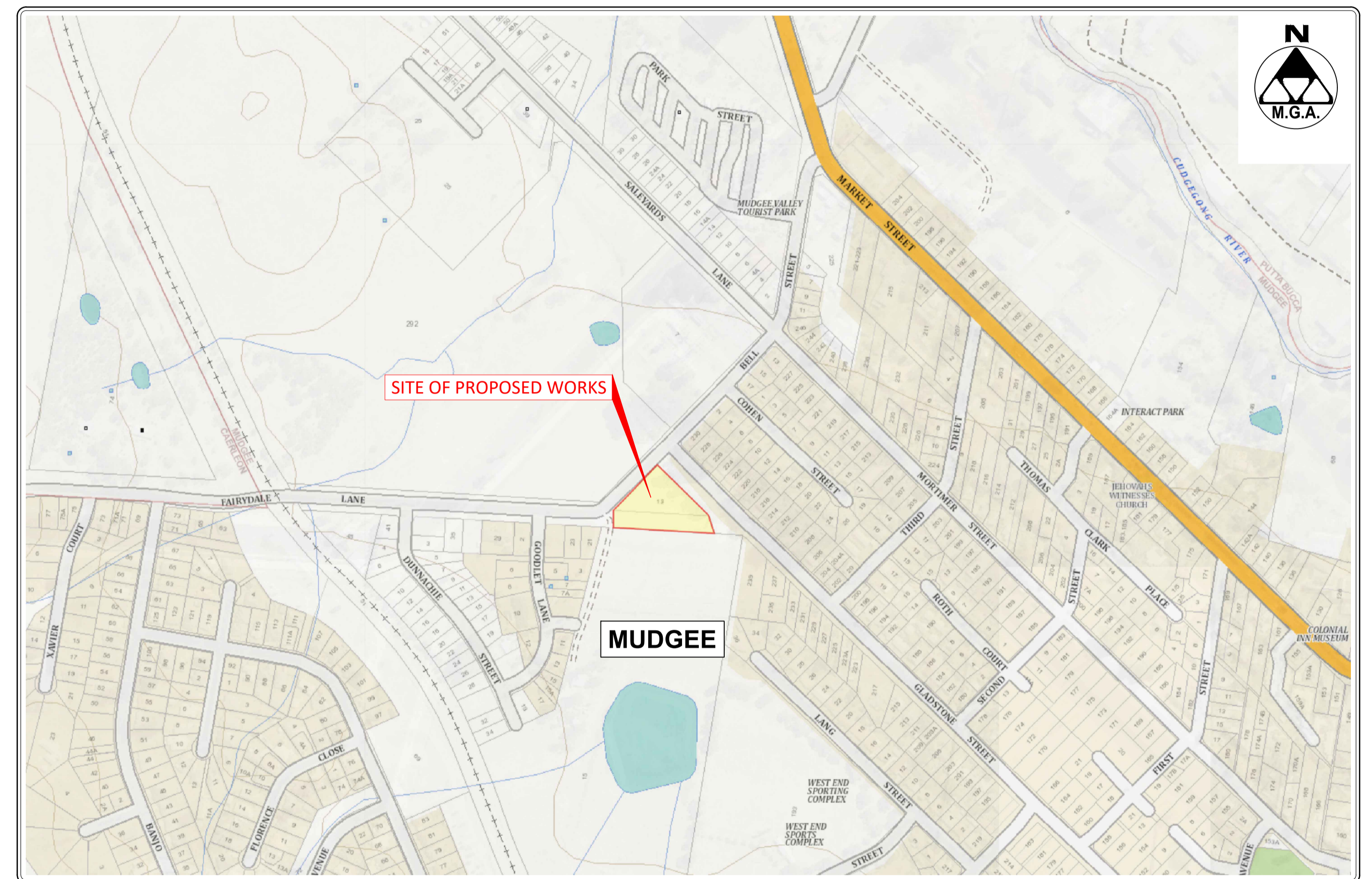

LOCALITY PLAN
REDUCTION RATIO 1:12500 @ A1

SUBMISSION FOR DA



KEY

- EXISTING SUBJECT CADASTRAL BOUNDARIES
- / — EXISTING FENCE LINE
- ===== EXISTING GATE
- TOP OF BANK
- BOTTOM OF BANK
- Ex. W — Ex. W — EXISTING UNDERGROUND WATER MAIN - APPROX.
- Ex. S — Ex. S — EXISTING UNDERGROUND SEWER PIPE - COUNCIL DIAGRAM APPROX
- Ex. E — Ex. E — EXISTING UNDERGROUND ELECTRICITY CABLES - APPROX
- Ex. OE — Ex. OE — EXISTING OVERHEAD ELECTRICITY CABLES
- Ex. T — Ex. T — EXISTING UNDERGROUND TELECOMMUNICATIONS ASSETS - DBYD - APPROX.
- Ex. TD — Ex. TD — EXISTING TABLE DRAIN
- Ex. SW — Ex. SW — DRAIN PIPE INVERT Ø525mm
- * EXISTING WATER METER
- ELECTRICITY POWER POLE
- WATER TAP
- FIRE HYDRANT
- WATER STOP VALVE
- SEWER MANHOLE
- GENERAL SIGN
- TELECOMMUNICATIONS PIT

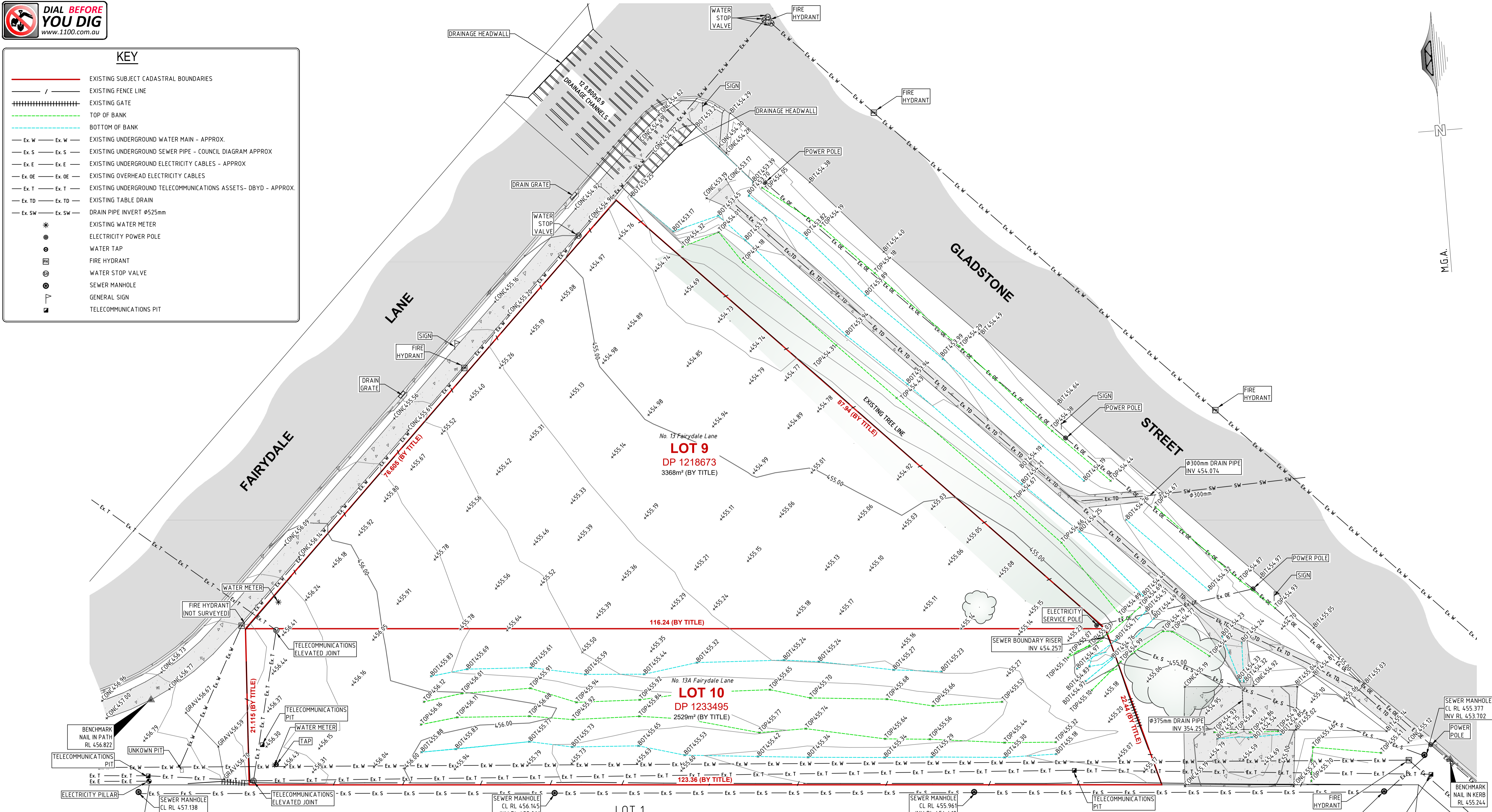

NOTES:

- THE BOUNDARY INFORMATION SHOWN ON THIS PLAN BEEN PLOTTED AS REQUIRED UNDER DIVISION 1, SECTION 9.1(1) OF THE "SURVEYING AND SPATIAL INFORMATION REGULATION 2017". IT HAS NOT BEEN DETERMINED BY AN ACCURATE BOUNDARY SURVEY.
- A DETAIL & LEVEL SURVEY IS NOT A "LAND SURVEY" AS DEFINED BY THE SURVEYING AND SPATIAL INFORMATION ACT 2002. IF ANY CONSTRUCTION OR DESIGN WORK WHICH RELIES ON CRITICAL SETBACKS FROM THE STREET OR BOUNDARIES IS PLANNED, IT WOULD BE IMPERATIVE TO CARRY OUT FURTHER SURVEY WORK TO DETERMINE THE BOUNDARY DIMENSIONS.
- THE LOCATIONS AND DEPTHS OF UNDERGROUND SERVICE LINES SHOWN ON THIS PLAN HAVE BEEN SCALED FROM RELEVANT AUTHORITY PLANS. IT IS RECOMMENDED THAT THE LOCATION OF THESE SERVICES SHOULD BE PRECISELY DETERMINED BY POT-HOLING PRIOR TO DESIGN AND CONSTRUCTION OR ANY EXCAVATION, DEMOLITION OR CONSTRUCTION COMMENCES. ALL MEASURES SHOULD BE TAKEN TO PROTECT THESE SERVICES FROM DAMAGE. THERE MAY BE UNDERGROUND SERVICES THAT HAVE NOT BEEN SHOWN HEREON. BARNSON TAKES NO RESPONSIBILITY FOR LOSSES, DAMAGES OR INJURIES TO ANY PERSON OR ORGANISATION THAT MAY OCCUR DUE TO THE RELIANCE ON THIS PLAN FOR THE LOCATION OF UNDERGROUND SERVICES.
- SERVICES LOCATED ONLY WHERE VISIBLE
- THE BENCHMARK PROVIDED IS FOR DETAILED PLANNING AND DESIGN IT IS TO BE CONFIRMED PRIOR TO USE FOR CONSTRUCTION ACTIVITY.

DATE OF SURVEY : 17th JANUARY 2024
 SURVEY BY : R. Boylan
 DATUM : AUSTRALIAN HEIGHT DATUM (A.H.D.)
 ORIGIN : SSM 77192 RL 447.505m (S.C.I.M.S.)
 MAJOR CONTOUR INTERVAL : 1 METRE
 MINOR CONTOUR INTERVAL : 0.25 METRES

EXISTING SITE PLAN
 REDUCTION RATIO 1:250 @ A1
 1:500 @ A3

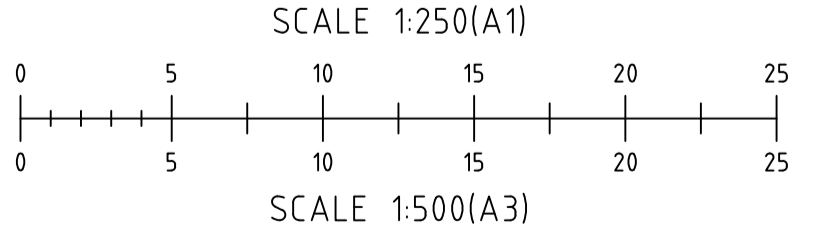

SUBMISSION FOR DA



BARNSON PTY LTD
 phone 1300 BARNSON (1300 227 676)
 email generalenquiry@barnson.com.au
 web barnson.com.au

Rev	Date	Description
A	6-02-2024	PRELIMINARY DRAWING
B	18-03-2024	ISSUED FOR DA

Project
**CIVIL DESIGN DOCUMENTATION
 PROPOSED SUBDIVISION**
 Site Address
 13 FAIRYDALE LANE
 MUDGEE NSW 2850
 Client
 SANDERSON & MACDONALD PTY LTD

Drawing Title
EXISTING SITE PLAN
 Design LM
 Drawn JS
 Check LM

Original Sheet Size A1
 Revision B
 Certification A1
 Project No 37880
 Drawing No C01



LEGEND (existing)

—	EXISTING SUBJECT CADASTRAL BOUNDARIES
—	EXISTING FENCE LINE
—	EXISTING GATE
— Ex. W — Ex. W	EXISTING UNDERGROUND WATER MAIN - APPROX.
— Ex. S — Ex. S	EXISTING UNDERGROUND SEWER PIPE - COUNCIL DIAGRAM APPROX
— Ex. E — Ex. E	EXISTING UNDERGROUND ELECTRICITY CABLES - APPROX
— Ex. OE — Ex. OE	EXISTING OVERHEAD ELECTRICITY CABLES
— Ex. T — Ex. T	EXISTING UNDERGROUND TELECOMMUNICATIONS ASSETS- DBYD - APPROX.
— Ex. TD — Ex. TD	EXISTING TABLE DRAIN
— Ex. SW — Ex. SW	DRAIN PIPE INVERT ϕ 525mm
*	EXISTING WATER METER
⊙	ELECTRICITY POWER POLE
⊙	WATER TAP
⊙	FIRE HYDRANT
⊙	WATER STOP VALVE
⊙	SEWER MANHOLE
⊙	GENERAL SIGN
⊙	TELECOMMUNICATIONS PIT

LEGEND (proposed)

▨	PROPOSED CONCRETE
▨	PROPOSED BITUMEN
—	PROPOSED KERB & GUTTER
—	PROPOSED BOUNDARY
—	PROPOSED EASEMENT BOUNDARY
— SW — SW	PROPOSED U/G STORMWATER DRAINAGE PIPE
⊙	PROPOSED STORMWATER INLET PIT
⊙	KERB INLET PIT
— S — S	PROPOSED U/G SEWER MAIN
⊙	PROPOSED SEWER MANHOLE
— W — W	PROPOSED U/G WATER MAIN
*	PROPOSED WATER METER
⊙	PROPOSED WATER HYDRANT
⊙	PROPOSED WATER STOP VALVE

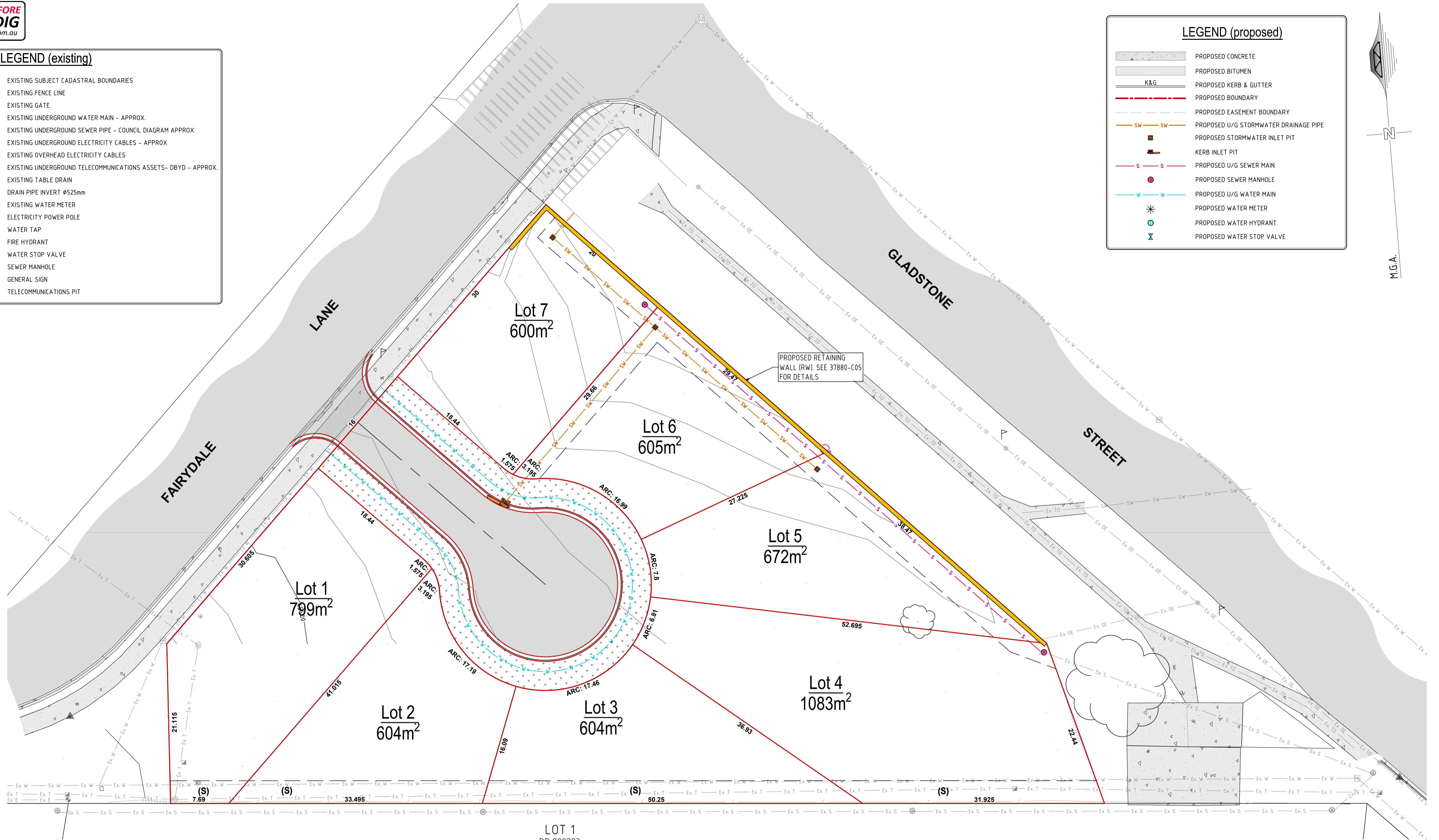
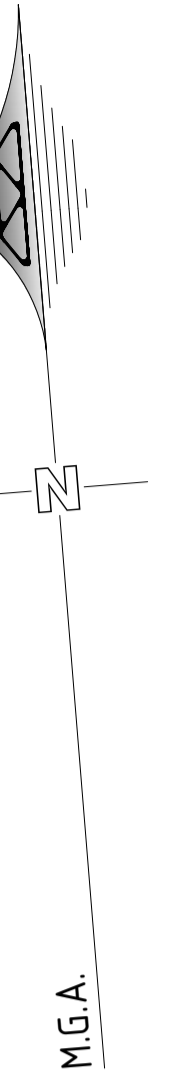

PROPOSED SITE PLAN
 REDUCTION RATIO 1:250 @ A1
 1:500 @ A3

(S) EASEMENT FOR SERVICES 3 WIDE

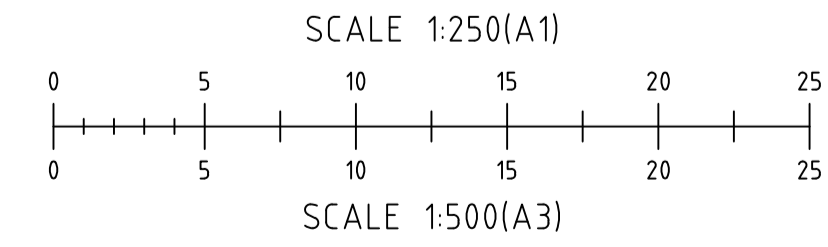

SUBMISSION FOR DA



BARNSON PTY LTD

phone 1300 BARNSON (1300 227 676)
 email generalenquiry@barnson.com.au
 web barnson.com.au

THIS DRAWING IS TO BE READ IN CONJUNCTION WITH GENERAL BUILDING DRAWINGS, SPECIFICATIONS & OTHER CONSULTANTS DRAWINGS APPLICABLE TO THIS PROJECT. ALL DIMENSIONS IN MILLIMETRES. DO NOT SCALE. DIMENSIONS TO BE CHECKED ON SITE BEFORE COMMENCEMENT OF WORK. REPORT DISCREPANCIES TO BARNSON PTY LTD. NO PART OF THIS DRAWING MAY BE REPRODUCED IN ANY WAY WITHOUT THE WRITTEN PERMISSION OF BARNSON PTY LTD.

Rev	Date	Description
A	6-02-2024	PRELIMINARY DRAWING
B	18-03-2024	ISSUED FOR DA

Project
CIVIL DESIGN DOCUMENTATION
PROPOSED SUBDIVISION
 Site Address
 13 FAIRYDALE LANE
 MUDGEE NSW 2850
 Client
 SANDERSON & MACDONALD PTY LTD

Drawing Title
PROPOSED SITE PLAN

Design LM
 Drawn JS
 Check LM

Original Sheet Size
 A1
 Revision
 B

Certification
 Project No
 Drawing No

37880
C02



LEGEND (existing)

	EXISTING SUBJECT CADASTRAL BOUNDARIES
	EXISTING FENCE LINE
	EXISTING GATE
	EXISTING UNDERGROUND WATER MAIN - APPROX.
	EXISTING UNDERGROUND SEWER PIPE - COUNCIL DIAGRAM APPROX
	EXISTING UNDERGROUND ELECTRICITY CABLES - APPROX
	EXISTING OVERHEAD ELECTRICITY CABLES
	EXISTING UNDERGROUND TELECOMMUNICATIONS ASSETS- DBYD - APPROX.
	EXISTING TABLE DRAIN
	DRAIN PIPE INVERT ϕ 525mm
	EXISTING WATER METER
	ELECTRICITY POWER POLE
	WATER TAP
	FIRE HYDRANT
	WATER STOP VALVE
	SEWER MANHOLE
	GENERAL SIGN
	TELECOMMUNICATIONS PIT

LEGEND (proposed)

	PROPOSED CONCRETE
	PROPOSED BITUMEN
	PROPOSED KERB & GUTTER
	PROPOSED BOUNDARY
	PROPOSED EASEMENT BOUNDARY
	PROPOSED U/G STORMWATER DRAINAGE PIPE
	PROPOSED STORMWATER INLET PIT
	KERB INLET PIT
	PROPOSED U/G SEWER MAIN
	PROPOSED SEWER MANHOLE
	PROPOSED U/G WATER MAIN
	PROPOSED WATER METER
	PROPOSED WATER HYDRANT
	PROPOSED WATER STOP VALVE

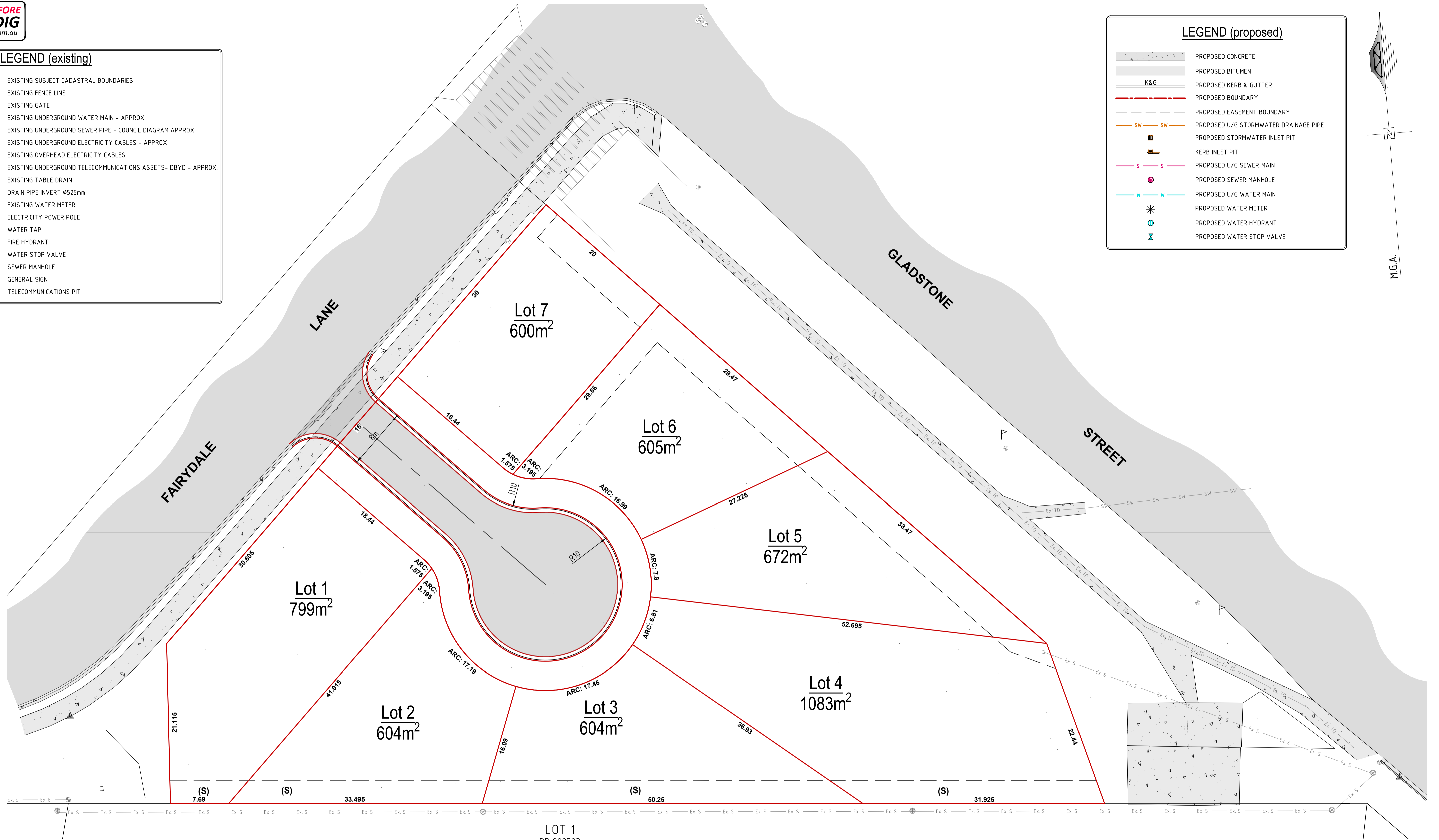
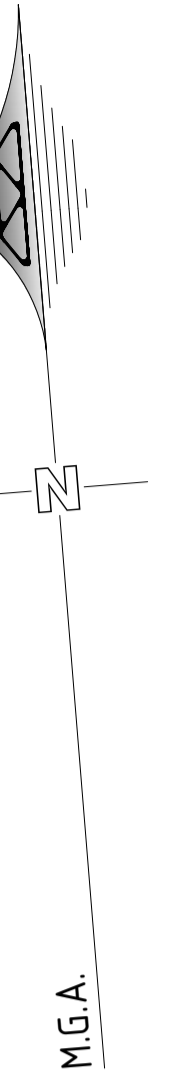

LOT 1
DP 999783

PROPOSED LOT PLAN
REDUCTION RATIO 1:250 @ A1
1:500 @ A3

(S) EASEMENT FOR SERVICES 3 WIDE

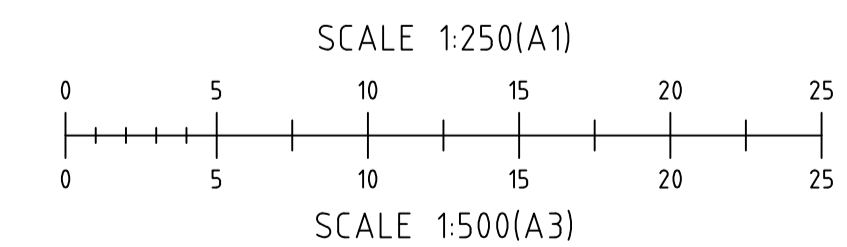

SUBMISSION FOR DA



BARNSON PTY LTD

phone 1300 BARNSON (1300 227 676)
email generalenquiry@barnson.com.au
web barnson.com.au

THIS DRAWING IS TO BE READ IN CONJUNCTION WITH GENERAL BUILDING DRAWINGS, SPECIFICATIONS & OTHER CONSULTANTS DRAWINGS APPLICABLE TO THIS PROJECT. ALL DIMENSIONS IN MILLIMETRES. DO NOT SCALE. DIMENSIONS TO BE CHECKED ON SITE BEFORE COMMENCEMENT OF WORK. REPORT DISCREPANCIES TO BARNSON PTY LTD. NO PART OF THIS DRAWING MAY BE REPRODUCED IN ANY WAY WITHOUT THE WRITTEN PERMISSION OF BARNSON PTY LTD.

Rev	Date	Description
A	6-02-2024	PRELIMINARY DRAWING
B	18-03-2024	ISSUED FOR DA

Project
**CIVIL DESIGN DOCUMENTATION
PROPOSED SUBDIVISION**
Site Address
13 FAIRYDALE LANE
MUDGEE NSW 2850
Client
SANDERSON & MACDONALD PTY LTD

Drawing Title
PROPOSED LOT PLAN

Design	LM	Original Sheet Size	A1
Drawn	JS	Revision	B
Check	LM		

Certification

Project No
Drawing No

37880
C03



LEGEND (existing)

—	EXISTING SUBJECT CADASTRAL BOUNDARIES
— / —	EXISTING FENCE LINE
	EXISTING GATE
— Ex. W — Ex. W	EXISTING UNDERGROUND WATER MAIN - APPROX.
— Ex. S — Ex. S	EXISTING UNDERGROUND SEWER PIPE - COUNCIL DIAGRAM APPROX
— Ex. E — Ex. E	EXISTING UNDERGROUND ELECTRICITY CABLES - APPROX
— Ex. OE — Ex. OE	EXISTING OVERHEAD ELECTRICITY CABLES
— Ex. T — Ex. T	EXISTING UNDERGROUND TELECOMMUNICATIONS ASSETS- DBYD - APPROX.
— Ex. TD — Ex. TD	EXISTING TABLE DRAIN
— Ex. SW — Ex. SW	DRAIN PIPE INVERT ϕ 525mm
*	EXISTING WATER METER
⊙	ELECTRICITY POWER POLE
⊙	WATER TAP
⊙	FIRE HYDRANT
⊙	WATER STOP VALVE
⊙	SEWER MANHOLE
⊙	GENERAL SIGN
⊙	TELECOMMUNICATIONS PIT

LEGEND (proposed)

▨	PROPOSED CONCRETE
▨	PROPOSED BITUMEN
— K&G —	PROPOSED KERB & GUTTER
—	PROPOSED BOUNDARY
—	PROPOSED EASEMENT BOUNDARY
— SW — SW	PROPOSED U/G STORMWATER DRAINAGE PIPE
⊙	PROPOSED STORMWATER INLET PIT
⊙	KERB INLET PIT
— S — S	PROPOSED U/G SEWER MAIN
⊙	PROPOSED SEWER MANHOLE
— W — W	PROPOSED U/G WATER MAIN
*	PROPOSED WATER METER
⊙	PROPOSED WATER HYDRANT
⊙	PROPOSED WATER STOP VALVE

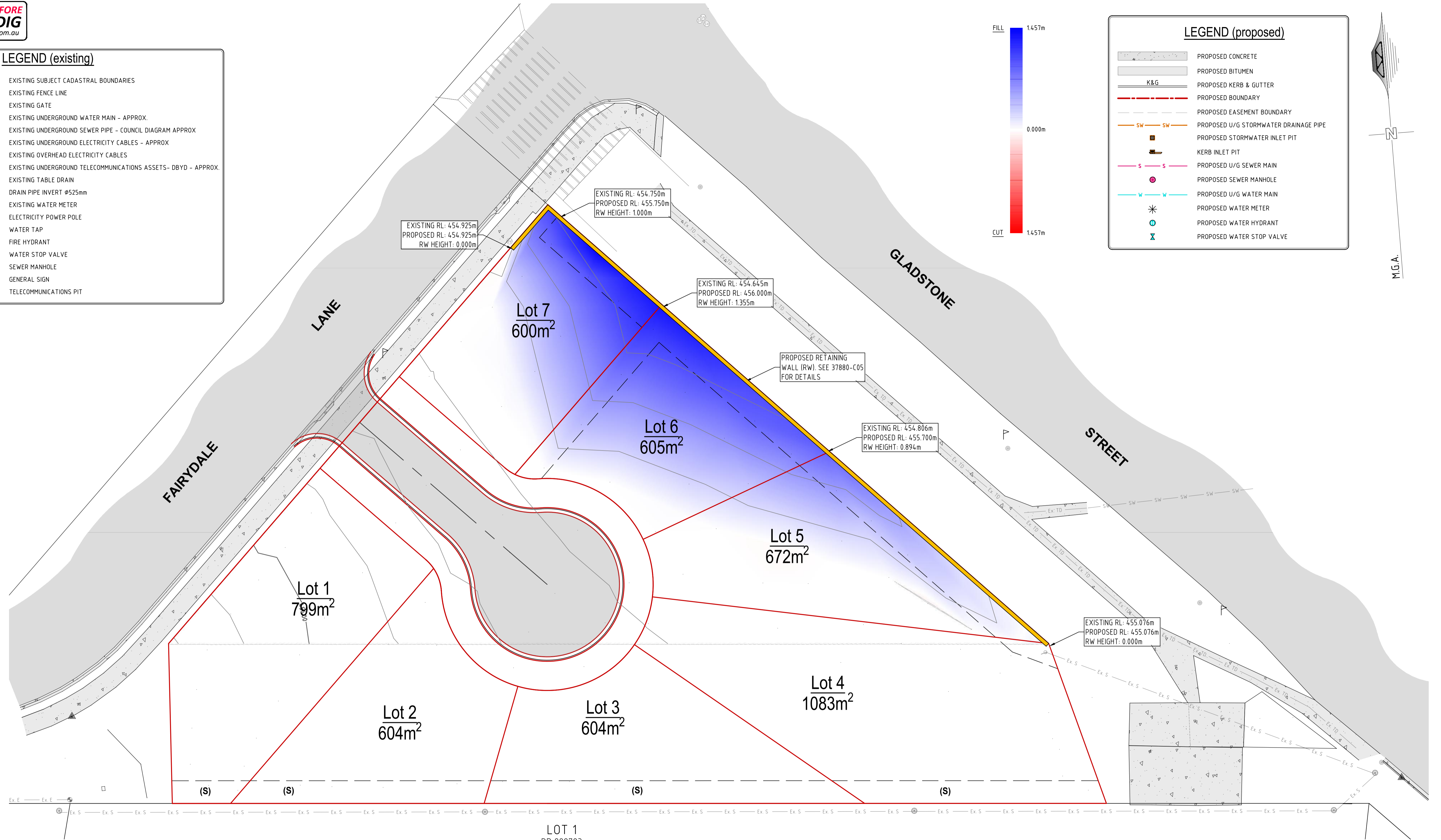
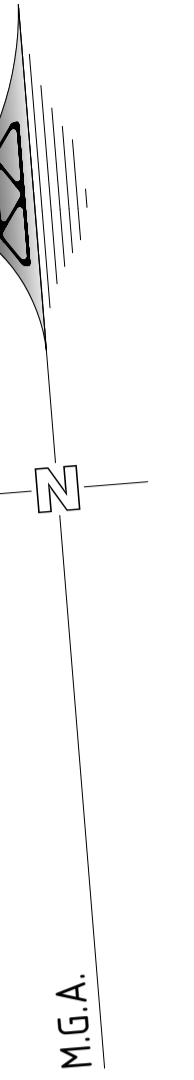
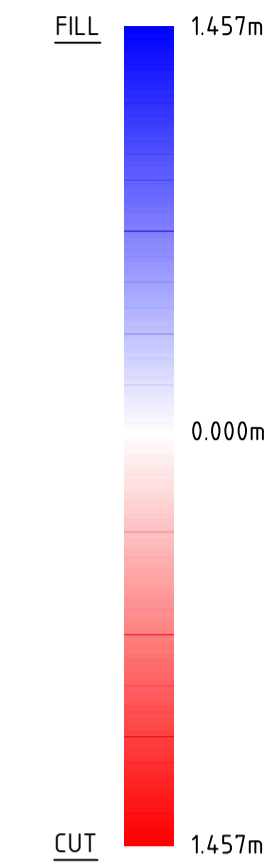

(S) EASEMENT FOR SERVICES 3 WIDE

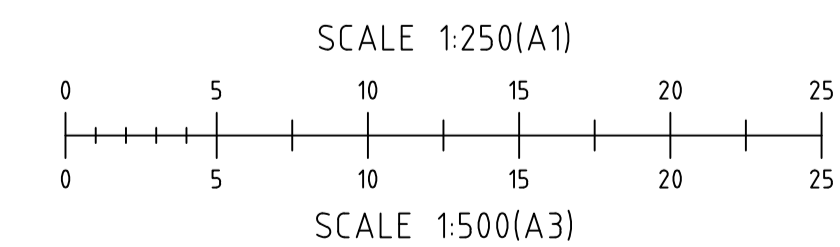

SUBMISSION FOR DA



BARNSON PTY LTD

phone 1300 BARNSON (1300 227 676)
email generalenquiry@barnson.com.au
web barnson.com.au

THIS DRAWING IS TO BE READ IN CONJUNCTION WITH GENERAL BUILDING DRAWINGS, SPECIFICATIONS & OTHER CONSULTANTS DRAWINGS APPLICABLE TO THIS PROJECT. ALL DIMENSIONS IN MILLIMETRES. DO NOT SCALE. DIMENSIONS TO BE CHECKED ON SITE BEFORE COMMENCEMENT OF WORK. REPORT DISCREPANCIES TO BARNSON PTY LTD. NO PART OF THIS DRAWING MAY BE REPRODUCED IN ANY WAY WITHOUT THE WRITTEN PERMISSION OF BARNSON PTY LTD.

Rev	Date	Description
A	6-02-2024	PRELIMINARY DRAWING
B	18-03-2024	ISSUED FOR DA

Project
**CIVIL DESIGN DOCUMENTATION
PROPOSED SUBDIVISION**
Site Address
13 FAIRYDALE LANE
MUDGEE NSW 2850
Client
SANDERSON & MACDONALD PTY LTD

Drawing Title	
PROPOSED BULK EARTHWORKS PLAN	
Design	LM
Drawn	JS
Check	LM
Original Sheet Size	A1
Revision	B

Certification
Project No
Drawing No

37880
C04

SITWORKS NOTES

- ORIGIN OF LEVELS :- AHD.
- SUB-CONTRACTOR MUST VERIFY ALL DIMENSIONS AND EXISTING LEVELS ON SITE PRIOR TO COMMENCEMENT OF WORK.
- ALL WORK IS TO BE UNDERTAKEN IN ACCORDANCE WITH THE DETAILS SHOWN ON THE DRAWINGS, THE SPECIFICATIONS AND THE DIRECTIONS OF THE SUPERINTENDENT.
- EXISTING SERVICES HAVE BEEN OBTAINED FROM SURFACE INSPECTION ONLY. IT IS THE RESPONSIBILITY OF THE SUB-CONTRACTOR TO ESTABLISH THE LOCATION AND LEVEL OF ALL EXISTING SERVICES PRIOR TO THE COMMENCEMENT OF ANY WORK. ANY DISCREPANCIES SHALL BE REPORTED TO THE SUPER-INTENDENT. CLEARANCES SHALL BE OBTAINED FROM THE RELEVANT SERVICE AUTHORITY.
- WHERE NEW WORKS ABUT EXISTING THE SUB-CONTRACTOR SHALL ENSURE THAT A SMOOTH EVEN PROFILE, FREE FROM ABRUPT CHANGES IS OBTAINED.
- THE SUB-SUB-CONTRACTOR SHALL ARRANGE ALL SURVEY SETOUT TO BE CARRIED OUT BY A REGISTERED SURVEYOR.
- CARE IS TO BE TAKEN WHEN EXCAVATING NEAR EXISTING SERVICES. NO MECHANICAL EXCAVATIONS ARE TO BE UNDERTAKEN OVER TELECOM OR ELECTRICAL SERVICES. HAND EXCAVATE IN THESE AREAS.
- ON COMPLETION OF CONSTRUCTION, ALL DISTURBED AREAS MUST BE RESTORED TO ORIGINAL, INCLUDING KERBS, FOOTPATHS, CONCRETE AREAS, GRAVEL AND GRASSED AREAS AND ROAD PAVEMENTS.
- MAKE SMOOTH TRANSITION TO EXISTING SURFACES.
- THE SUB-CONTRACTOR SHALL PROVIDE ALL TEMPORARY DIVERSION DRAINS AND MOUNDS TO ENSURE THAT AT ALL TIMES EXPOSED SURFACES ARE FREE DRAINING AND WHERE NECESSARY EXCAVATE SUMPS AND PROVIDE PUMPING EQUIPMENT TO DRAIN EXPOSED AREAS. ALL WORK TO BE UNDERTAKEN WITH ADHERENCE TO THE REQUIREMENTS OF THE SOIL AND WATER MANAGEMENT PLAN.
- THESE PLANS SHALL BE READ IN CONJUNCTION WITH APPROVED ARCHITECTURAL, STRUCTURAL, HYDRAULIC AND MECHANICAL DRAWINGS AND SPECIFICATIONS.

BULK EARTHWORKS APPROVALS

- APPROVAL IS REQUIRED BY ALL RELEVANT AUTHORITIES PRIOR TO COMMENCEMENT OF WORKS ON SITE.
- THE BULK EARTHWORKS PLANS AND ALL SUPPORTING INFORMATION INCLUDING ALL EROSION AND SEDIMENT CONTROL PLANS SHALL REMAIN ON SITE AT ALL TIMES.

EXISTING SERVICES

- EXACT LOCATION OF ALL SERVICES SHALL BE LOCATED PRIOR TO THE COMMENCEMENT OF WORK. IT IS THE BUILDERS RESPONSIBILITY TO CONFIRM THE DEPTH AND LOCATION OF SERVICES AND BARNSON PTY LTD ACCEPTS NO RESPONSIBILITY FOR THE COMPLETENESS OR ACCURACY OF THE SERVICES SHOWN.

ADJOINING PROPERTY

- IT IS THE SUB-CONTRACTOR'S RESPONSIBILITY TO ENSURE THE EFFECTS OF THE EARTHWORKS DO NOT HAVE AN IMPACT TO THE NEIGHBOURING PROPERTIES. SHOULD AN ISSUE ARISE ON SITE, THE SUB-CONTRACTOR SHALL INFORM THE SUPERINTENDENT IMMEDIATELY.

- THE SUB-CONTRACTOR IS TO RECEIVE WRITTEN PERMISSION PRIOR TO ENTERING OR COMMENCING WORK OUTSIDE THE DEVELOPMENT SITE AND SHALL RECEIVE PERMISSION FROM EASEMENT HOLDERS AND LOCAL AUTHORITY PRIOR TO WORK COMMENCING.

AUTHORITY REGULATIONS

- HAUL ROUTES FROM SITE IS TO BE AS FOLLOWS: SITE > TO BE CONFIRMED, STAY ON MAIN ROADS.

- ALL EROSION AND SEDIMENT CONTROL MEASURES SHALL BE INSTALLED PRIOR TO WORK COMMENCING AS REQUIRED BY THE COUNCIL APPROVED SEDIMENT & EROSION CONTROL PLAN.

- ALL VEGETATION PROTECTION AND PRESERVATION MEASURES SHALL BE INSTALLED PRIOR TO COMMENCEMENT OF WORK.

SOIL CONTAMINATION

- ANY SUSPECTED GROUND OR GROUND WATER CONTAMINATION SHALL BE INVESTIGATED BY A SUITABLY QUALIFIED GEOTECHNICAL ENGINEER.

CONSTRUCTION RECORDS

- ADEQUATE RECORDS SHALL BE KEPT THROUGHOUT CONSTRUCTION INCLUDING, BUT NOT LIMITED TO;
 - LOCATION AND QUANTITY OF EXCESS CUT (DUMP SITE);
 - THE AREAS ON SITE OF ALL FILL;
 - LEVELS OF STRIPPED SURFACE;
 - LOCATION OF ANY VEGETATION REMOVED;
 - LOCATION OF SITE CONTAMINATION/UNSUITABLE MATERIAL;
 - LEVELS AT COMPLETION OF BULK EARTHWORKS WORK;
 - DETAILS OF SUB-GRADE TEST ROLLING (PROOF ROLLING);
 - TYPES/SOURCE OF FILL MATERIAL;
 - LOCATION LEVEL AND RESULT OF EACH COMPACTION TEST;
 - RECORD OF ALL ACTIONS TAKEN ON SITE.

UNSUITABLE MATERIALS

- REFER TO GEOTECHNICAL ENGINEER, AS REQUIRED, FOR DETERMINATION OF SUITABILITY OF MATERIAL WON ON SITE, OR BORROW PIT TO BE USED AS FILL MATERIAL.
- ALL UNSUITABLE FILL SHALL BE EITHER REMOVED OR USED ORGANIC MATTER FROM BUILDING AND PAVEMENT AREAS TO AN
- PRIOR TO ANY EARTHWORKS STRIP TOPSOIL, CONTAINING AS PER THE RECOMMENDATIONS IN THE GEOTECHNICAL REPORT. APPROXIMATE DEPTH OF 0.10M. SPOIL MATERIAL AS DIRECTED BY THE MANAGER. REMOVE RUBBLE, OVER SATURATED MATERIALS AND ALL ORGANIC MATTER.

TESTING/INSPECTIONS

- ALL TESTING OF EARTHWORKS SHALL BE DONE AT THE SUB-CONTRACTOR'S EXPENSE, UNLESS NOTED OTHERWISE. SHALL A SUB-GRADE OR PROOF ROLL INSPECTION FAIL, OR 2. ADDITIONAL INSPECTIONS BE REQUIRED FOR ANY REASON OUTSIDE, THE SUB-CONTRACTOR WILL WEAR THE COSTS OF ANY SUBSEQUENT RE-INSPECTIONS UNLESS NOTED OTHERWISE.

EARTHWORKS SEQUENCE

- INSTALL ALL VEGETATION PROTECTION, EROSION AND SEDIMENT CONTROL, AND SITE-SPECIFIC MEASURES PRIOR TO THE COMMENCEMENT OF ANY WORK.
- STRIP ALL TOPSOIL/ORGANIC MATERIAL FROM CONSTRUCTION AREA AND REMOVE FROM SITE OR STOCKPILE AS DIRECTED BY THE SUPERINTENDENT.
- EXCAVATE MATERIAL AS INDICATED ON THE BULK EARTHWORKS PLAN.
- PRIOR TO PLACING FILL, PROOF ROLL EXPOSED SUB-GRADE WITH AN 8 TONNE (MINIMUM) ROLLER OR WATER TRUCK TO DETECT THEN REMOVE SOFT SPOTS, REPLACE UNSUITABLE MATERIAL WITH SUITABLE GRANULAR MATERIAL AND COMPACT TO THE MINIMUM COMPACTION REQUIREMENTS LISTED. (TO BE UNDERTAKEN IN THE PRESENCE OF A CIVIL/GEOTECHNICAL ENGINEER
- GEOTECHNICAL ENGINEER TO UNDERTAKE SUB-GRADE COMPACTION TESTING TO LEVEL 1, AS PER AS 3798 (2007) AND PROVIDE CBR VALUES FOR ADJUSTMENT TO PAVEMENT DESIGN.
- FILLING IS TO BE PLACED AND COMPACTED IN MAXIMUM 150MM LAYERS AND TO THE MINIMUM COMPACTION REQUIREMENTS LISTED.
- AFTER ALL BULK EARTHWORKS HAVE OCCURRED, PROOF ROLL THE FINISHED PAD LEVEL WITH AN 8 TONNE (MINIMUM) ROLLER OR WATER TRUCK TO DETECT, THEN REMOVE SOFT SPOTS, REPLACE UNSUITABLE MATERIAL WITH SUITABLE GRANULAR MATERIAL AND COMPACT TO THE MINIMUM COMPACTION REQUIREMENTS LISTED.

SCOUR PROTECTION NOTES

- SCOUR PROTECTION IS TO BE PROVIDED AS A 3000mm WIDE DISTRIBUTION x 300mm DEEP D₅₀100mm RIP RAP PLACED ON A SINGLE LAYER OF GEOTEXTILE (BIDIM A34 OR EQUIVALENT)
- GRADING TO BE AS PER TABLE BELOW

EQUIVALENT SPHERICAL DIAMETER ##	PERCENT (BY WEIGHT) OF RIP RAP OF SMALLER SIZE
1.5 - 2.0 TIMES D ₅₀	100%
D ₅₀	50%
0.3 D ₅₀	10 - 20%

- ## THE DIAMETER OF A SPHERE WITH AN EQUIVALENT VOLUME TO THE INDIVIDUAL ROCK.
- ++ D₅₀ IS THE MEDIAN RIP RAP DIAMETER OF THE ROCK MIX. (i.e. 50% (BY WEIGHT) IS SMALLER AND 50% (BY WEIGHT) IS LARGER).

TYPICAL EARTHWORKS EMBANKMENT NOTES

- IT IS THE BUILDER'S RESPONSIBILITY TO ENSURE THAT THE SITE WORKS DO NOT COMPROMISE/UNDERMINE OR PLACE ADDITIONAL SURCHARGE ON ANY EXISTING STRUCTURES.
- BATTER ANGLES MUST COMPLY WITH LOCAL AUTHORITY REQUIREMENTS AND ARE TO CONFORM TO THE ABOVE DIAGRAM.
- ALL BATTERS SHALL BE PROTECTED FROM EROSION, AND ADEQUATE EROSION AND SEDIMENT CONTROL MEASURES IN PLACE PRIOR TO THE COMMENCEMENT OF WORK.
- SHOULD THE ABOVE CONDITIONS NOT BE ACHIEVED, BARNSON MUST BE CONTACTED PRIOR TO ANY SITE WORKS BEING UNDERTAKEN.

PAD AND FINISHED LEVEL NOTES

- ACTUAL FINISHED LEVELS SHOWN ON THIS PLAN ARE FOR THE SUB-CONTRACTOR'S GUIDANCE ONLY. ACTUAL FINISHED LEVELS SHALL BE SET-OUT IN ACCORDANCE WITH ARCHITECTURAL PLANS (REPORT ANY DISCREPANCIES TO BARNSON IMMEDIATELY).

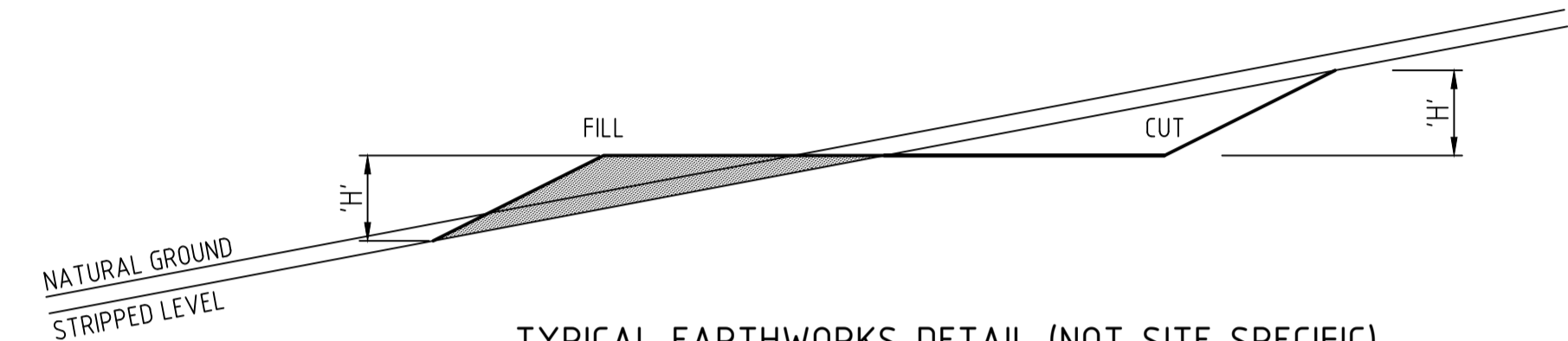

TYPICAL EARTHWORKS DETAIL (NOT SITE SPECIFIC) NOT TO SCALE

BATTER ANGLES - SHORT TERM

SLOPE = H:L H+2m	MATERIAL TYPE (REFER GEOTECHNICAL REPORT)					
	STABLE ROCK	SAND	SILT	FIRM CLAY	SOFT CLAY	SOFT SOILS
COMPACTED FILL	1:1	1:3	1:4	1:2	N/A	N/A
CUTTING	N/A	1:3	1:4	1:2	1:3	N/A

N/A = REFER TO GEOTECHNICAL REPORT FOR TREATMENT OF UNSUITABLE MATERIAL
ALL BATTER ANGLES ARE APPROXIMATE ONLY AND SHOULD BE CONFIRMED BY A GEOTECHNICAL ENGINEER.

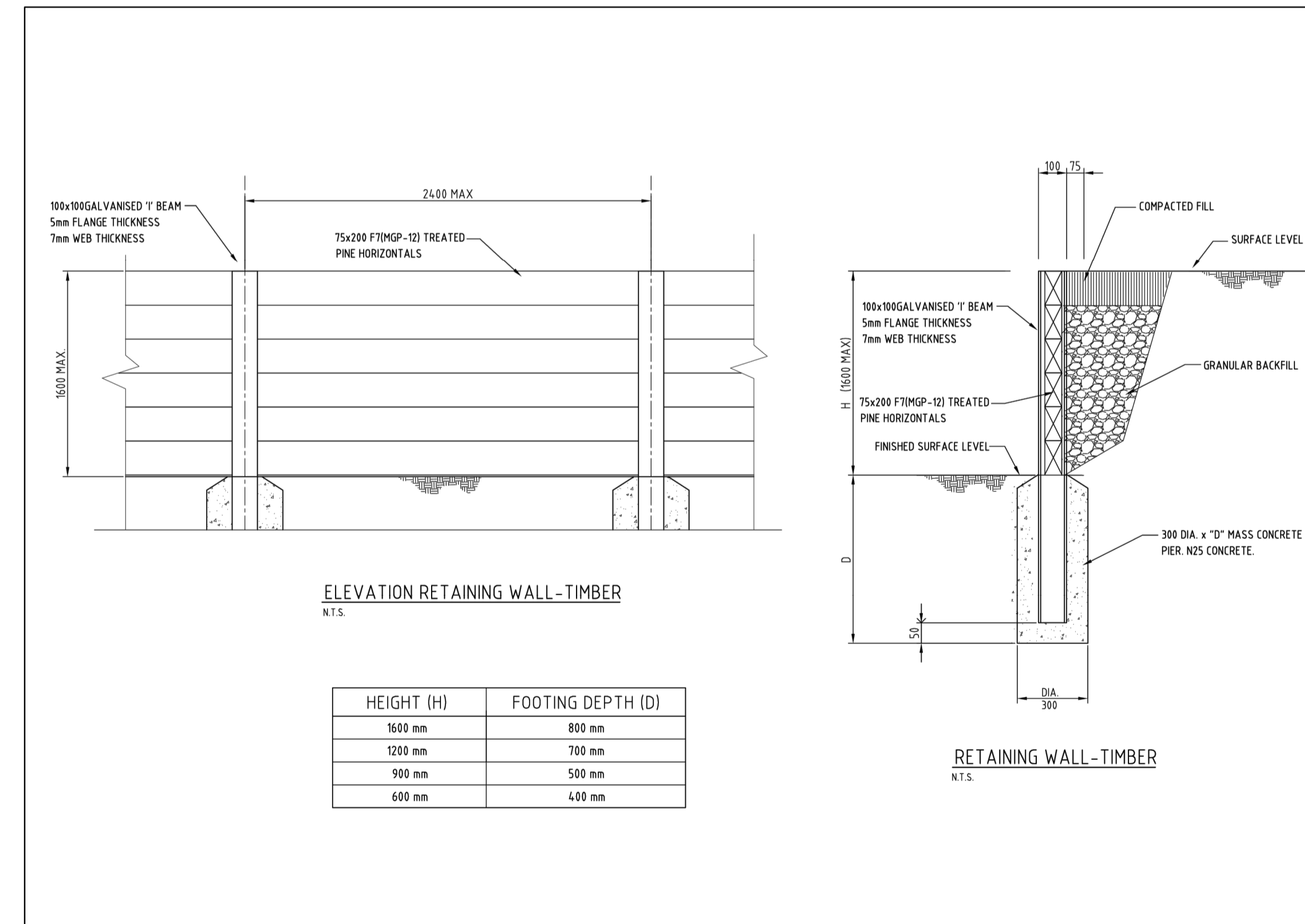

PROPOSED RETAINING WALL - SECTION



LEGEND (existing)

- EXISTING SUBJECT CADASTRAL BOUNDARIES
- EXISTING FENCE LINE
- EXISTING GATE
- Ex. W — Ex. W — EXISTING UNDERGROUND WATER MAIN - APPROX.
- Ex. S — Ex. S — EXISTING UNDERGROUND SEWER PIPE - COUNCIL DIAGRAM APPROX
- Ex. E — Ex. E — EXISTING UNDERGROUND ELECTRICITY CABLES - APPROX
- Ex. OE — Ex. OE — EXISTING OVERHEAD ELECTRICITY CABLES
- Ex. T — Ex. T — EXISTING UNDERGROUND TELECOMMUNICATIONS ASSETS- DBYD - APPROX.
- Ex. TD — Ex. TD — EXISTING TABLE DRAIN
- Ex. SW — Ex. SW — DRAIN PIPE INVERT ϕ 525mm
- * EXISTING WATER METER
- ⊙ ELECTRICITY POWER POLE
- ⊙ WATER TAP
- ⊙ FIRE HYDRANT
- ⊙ WATER STOP VALVE
- ⊙ SEWER MANHOLE
- ⊙ GENERAL SIGN
- ⊙ TELECOMMUNICATIONS PIT

LEGEND (proposed)

- ▨ PROPOSED CONCRETE
- ▨ PROPOSED BITUMEN
- K&G — PROPOSED KERB & GUTTER
- PROPOSED BOUNDARY
- PROPOSED EASEMENT BOUNDARY
- SW — SW — PROPOSED U/G STORMWATER DRAINAGE PIPE
- ⊙ PROPOSED STORMWATER INLET PIT
- ⊙ KERB INLET PIT
- S — S — PROPOSED U/G SEWER MAIN
- ⊙ PROPOSED SEWER MANHOLE
- W — W — PROPOSED U/G WATER MAIN
- * PROPOSED WATER METER
- ⊙ PROPOSED WATER HYDRANT
- ⊙ PROPOSED WATER STOP VALVE

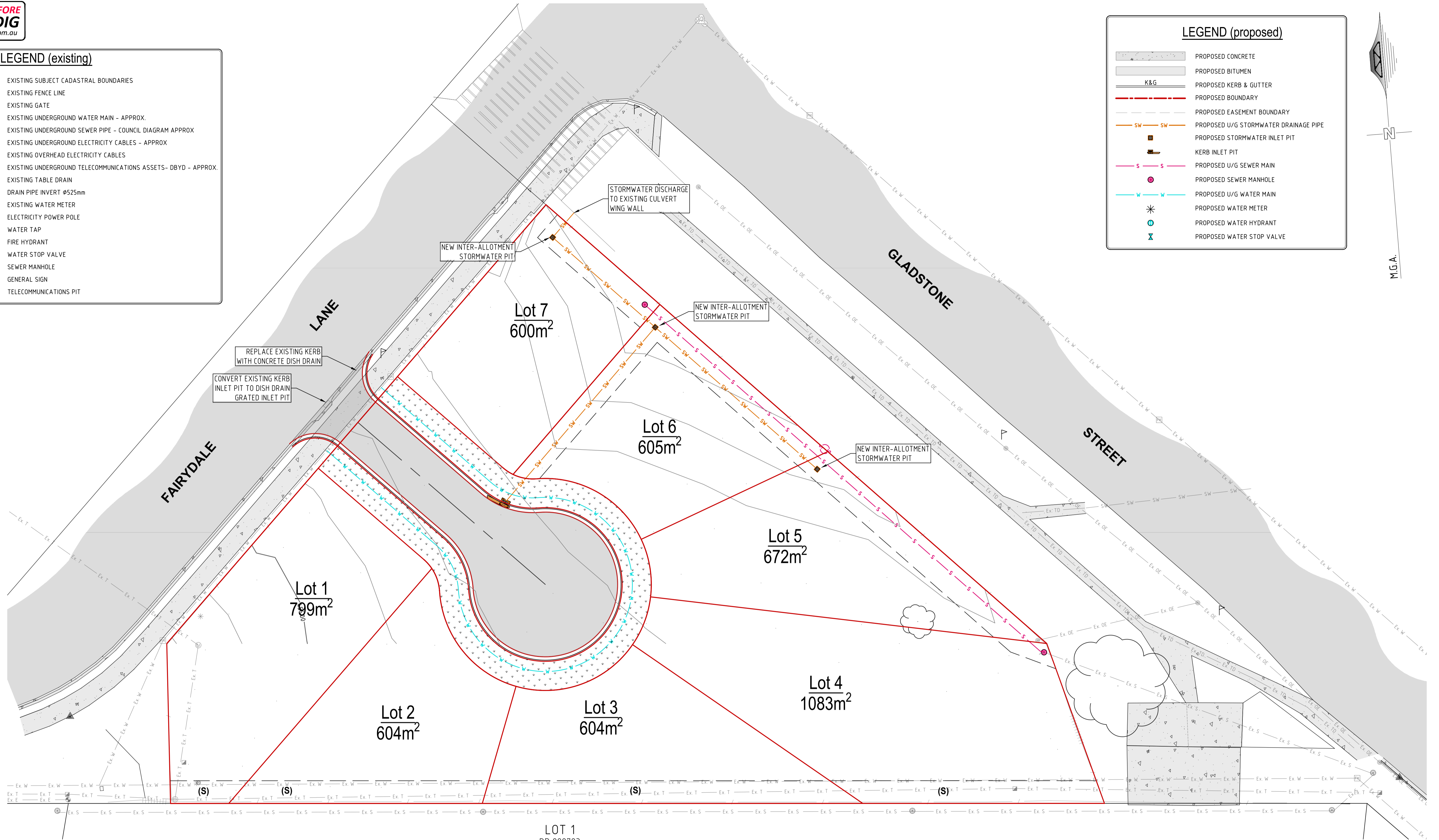
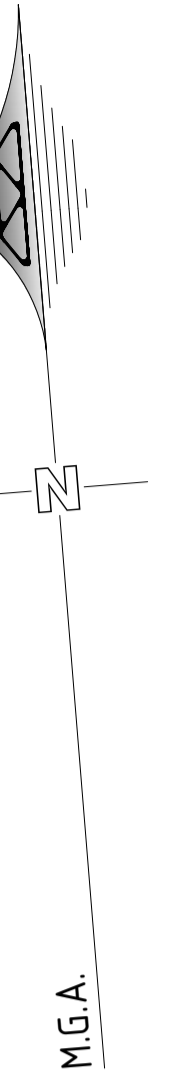

PROPOSED STORMWATER PLAN
 REDUCTION RATIO 1:250 @ A1
 1:500 @ A3

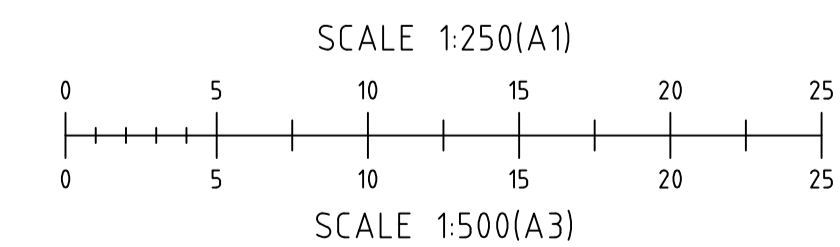

(S) EASEMENT FOR SERVICES 3 WIDE

SUBMISSION FOR DA



BARNSON PTY LTD

phone 1300 BARNSON (1300 227 676)
 email generalenquiry@barnson.com.au
 web barnson.com.au

THIS DRAWING IS TO BE READ IN CONJUNCTION WITH GENERAL BUILDING DRAWINGS, SPECIFICATIONS & OTHER CONSULTANTS DRAWINGS APPLICABLE TO THIS PROJECT. ALL DIMENSIONS IN MILLIMETRES. DO NOT SCALE. DIMENSIONS TO BE CHECKED ON SITE BEFORE COMMENCEMENT OF WORK. REPORT DISCREPANCIES TO BARNSON PTY LTD. NO PART OF THIS DRAWING MAY BE REPRODUCED IN ANY WAY WITHOUT THE WRITTEN PERMISSION OF BARNSON PTY LTD.

Rev	Date	Description
A	6-02-2024	PRELIMINARY DRAWING
B	18-03-2024	ISSUED FOR DA

Project
CIVIL DESIGN DOCUMENTATION
PROPOSED SUBDIVISION
 Site Address
 13 FAIRYDALE LANE
 MUDGEE NSW 2850
 Client
 SANDERSON & MACDONALD PTY LTD

Drawing Title		Certification	
PROPOSED STORMWATER PLAN		Project No	37880
Design	LM	Drawing No	C06
Drawn	JS		
Check	LM		
Original Sheet Size	A1		
Revision	B		



LEGEND (existing)

—	EXISTING SUBJECT CADASTRAL BOUNDARIES
— / —	EXISTING FENCE LINE
	EXISTING GATE
— Ex. W — Ex. W	EXISTING UNDERGROUND WATER MAIN - APPROX.
— Ex. S — Ex. S	EXISTING UNDERGROUND SEWER PIPE - COUNCIL DIAGRAM APPROX
— Ex. E — Ex. E	EXISTING UNDERGROUND ELECTRICITY CABLES - APPROX
— Ex. OE — Ex. OE	EXISTING OVERHEAD ELECTRICITY CABLES
— Ex. T — Ex. T	EXISTING UNDERGROUND TELECOMMUNICATIONS ASSETS- DBYD - APPROX.
— Ex. TD — Ex. TD	EXISTING TABLE DRAIN
— Ex. SW — Ex. SW	DRAIN PIPE INVERT ϕ 525mm
*	EXISTING WATER METER
⊙	ELECTRICITY POWER POLE
⊙	WATER TAP
⊙	FIRE HYDRANT
⊙	WATER STOP VALVE
⊙	SEWER MANHOLE
⊙	GENERAL SIGN
⊙	TELECOMMUNICATIONS PIT

LEGEND (proposed)

—	PROPOSED CONCRETE
—	PROPOSED BITUMEN
—	PROPOSED KERB & GUTTER
—	PROPOSED BOUNDARY
—	PROPOSED EASEMENT BOUNDARY
— SW — SW	PROPOSED U/G STORMWATER DRAINAGE PIPE
⊙	PROPOSED STORMWATER INLET PIT
⊙	KERB INLET PIT
— S — S	PROPOSED U/G SEWER MAIN
⊙	PROPOSED SEWER MANHOLE
— W — W	PROPOSED U/G WATER MAIN
*	PROPOSED WATER METER
⊙	PROPOSED WATER HYDRANT
⊙	PROPOSED WATER STOP VALVE

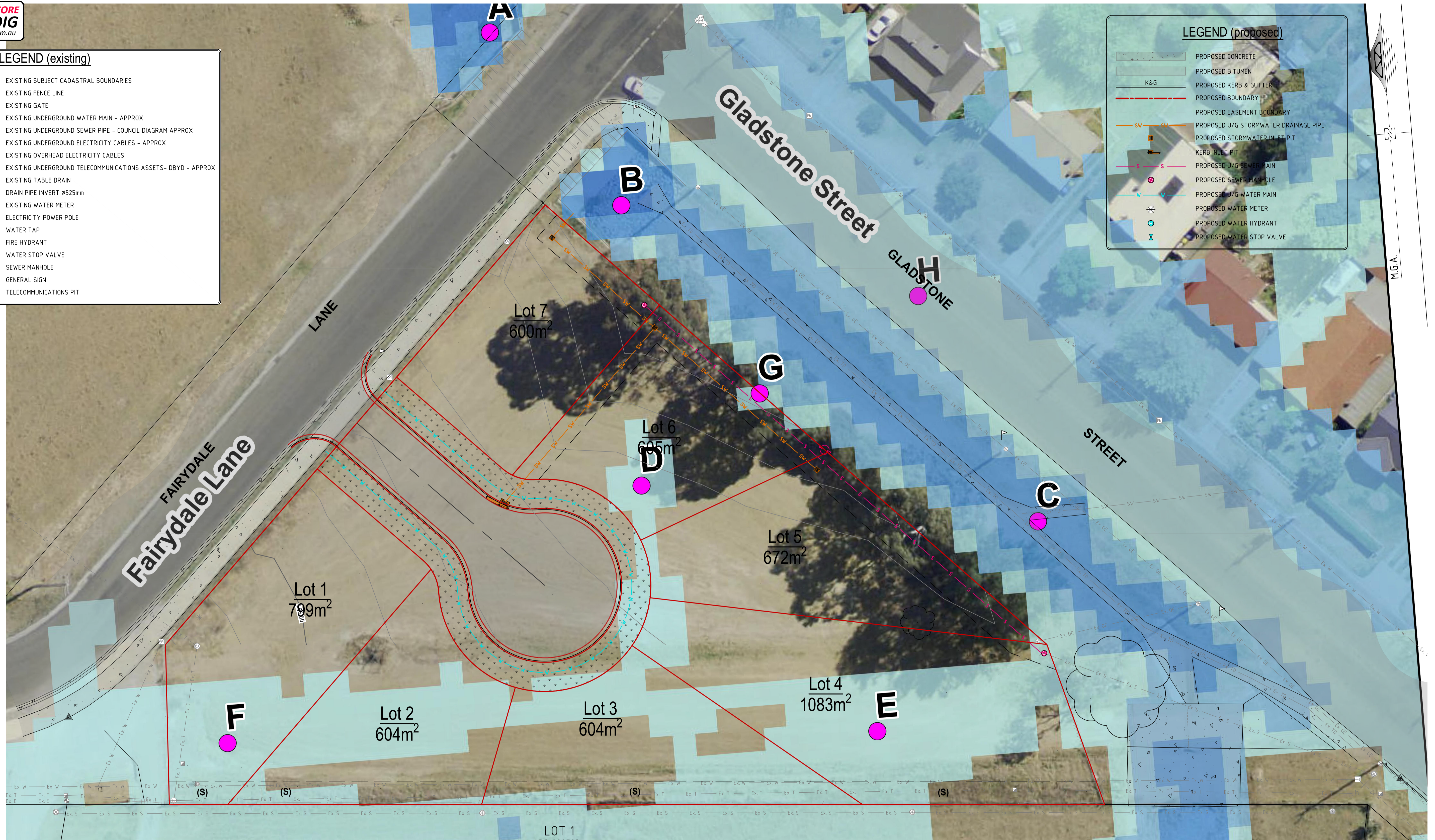

PROPOSED FLOOD IMPACT PLAN
 REDUCTION RATIO 1:250 @ A1
 1:500 @ A3

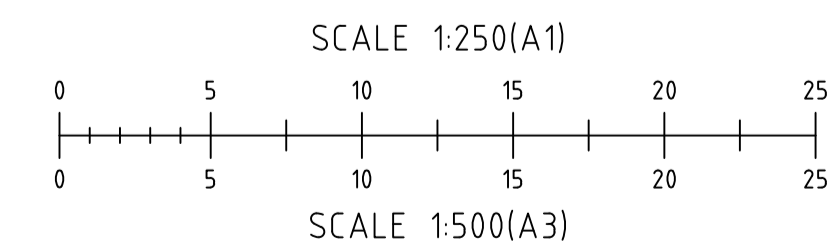

(S) EASEMENT FOR SERVICES 3 WIDE

SUBMISSION FOR DA



BARNSON PTY LTD

phone 1300 BARNSON (1300 227 676)
 email generalenquiry@barnson.com.au
 web barnson.com.au

THIS DRAWING IS TO BE READ IN CONJUNCTION WITH GENERAL BUILDING DRAWINGS, SPECIFICATIONS & OTHER CONSULTANTS DRAWINGS APPLICABLE TO THIS PROJECT. ALL DIMENSIONS IN MILLIMETRES. DO NOT SCALE. DIMENSIONS TO BE CHECKED ON SITE BEFORE COMMENCEMENT OF WORK. REPORT DISCREPANCIES TO BARNSON PTY LTD. NO PART OF THIS DRAWING MAY BE REPRODUCED IN ANY WAY WITHOUT THE WRITTEN PERMISSION OF BARNSON PTY LTD.

Rev	Date	Description
A	6-02-2024	PRELIMINARY DRAWING
B	18-03-2024	ISSUED FOR DA

Project
CIVIL DESIGN DOCUMENTATION
PROPOSED SUBDIVISION
 Site Address
 13 FAIRYDALE LANE
 MUDGEE NSW 2850
 Client
 SANDERSON & MACDONALD PTY LTD

Drawing Title	
PROPOSED FLOOD IMPACT PLAN	
Design	LM
Drawn	JS
Check	LM
Original Sheet Size	A1
Revision	B

Certification
 Project No
 Drawing No

37880
C07



LEGEND (existing)

—	EXISTING SUBJECT CADASTRAL BOUNDARIES
—	EXISTING FENCE LINE
—	EXISTING GATE
— Ex. W — Ex. W	EXISTING UNDERGROUND WATER MAIN - APPROX.
— Ex. S — Ex. S	EXISTING UNDERGROUND SEWER PIPE - COUNCIL DIAGRAM APPROX
— Ex. E — Ex. E	EXISTING UNDERGROUND ELECTRICITY CABLES - APPROX
— Ex. OE — Ex. OE	EXISTING OVERHEAD ELECTRICITY CABLES
— Ex. T — Ex. T	EXISTING UNDERGROUND TELECOMMUNICATIONS ASSETS- DBYD - APPROX.
— Ex. TD — Ex. TD	EXISTING TABLE DRAIN
— Ex. SW — Ex. SW	DRAIN PIPE INVERT ϕ 525mm
*	EXISTING WATER METER
⊕	ELECTRICITY POWER POLE
⊕	WATER TAP
⊕	FIRE HYDRANT
⊕	WATER STOP VALVE
⊕	SEWER MANHOLE
⊕	GENERAL SIGN
⊕	TELECOMMUNICATIONS PIT

LEGEND (proposed)

▨	PROPOSED CONCRETE
▨	PROPOSED BITUMEN
—	PROPOSED KERB & GUTTER
—	PROPOSED BOUNDARY
—	PROPOSED EASEMENT BOUNDARY
— SW — SW	PROPOSED U/G STORMWATER DRAINAGE PIPE
⊕	PROPOSED STORMWATER INLET PIT
⊕	KERB INLET PIT
— S — S	PROPOSED U/G SEWER MAIN
⊕	PROPOSED SEWER MANHOLE
— W — W	PROPOSED U/G WATER MAIN
*	PROPOSED WATER METER
⊕	PROPOSED WATER HYDRANT
⊕	PROPOSED WATER STOP VALVE

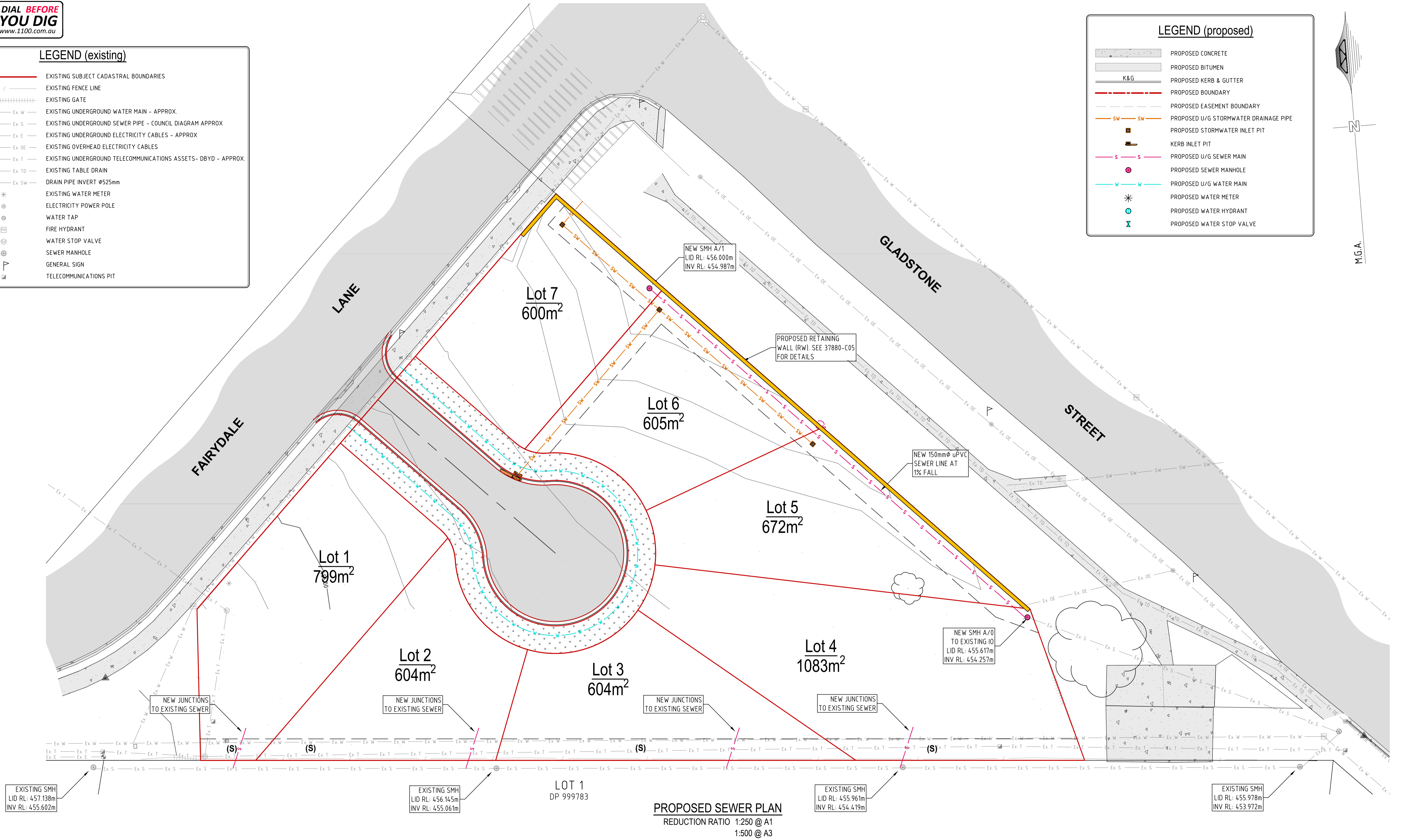
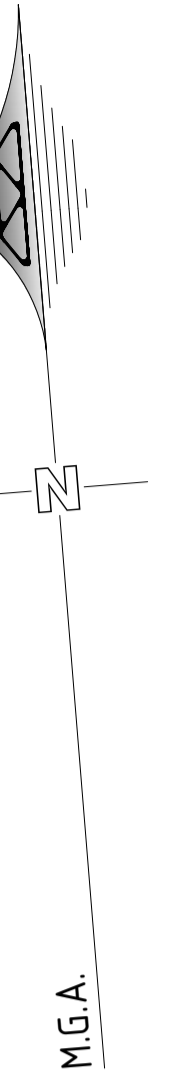

(S) EASEMENT FOR SERVICES 3 WIDE

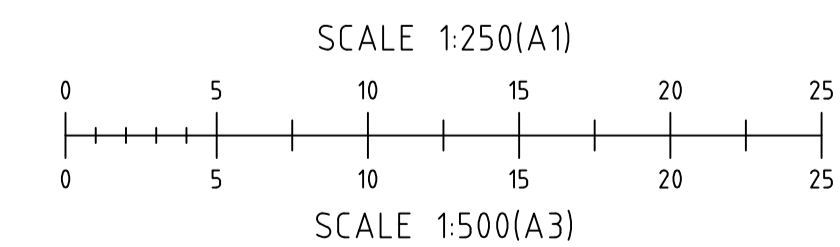

SUBMISSION FOR DA



BARNSON PTY LTD

phone 1300 BARNSON (1300 227 676)
email generalenquiry@barnson.com.au
web barnson.com.au

THIS DRAWING IS TO BE READ IN CONJUNCTION WITH GENERAL BUILDING DRAWINGS, SPECIFICATIONS & OTHER CONSULTANTS DRAWINGS APPLICABLE TO THIS PROJECT. ALL DIMENSIONS IN MILLIMETRES. DO NOT SCALE. DIMENSIONS TO BE CHECKED ON SITE BEFORE COMMENCEMENT OF WORK. REPORT DISCREPANCIES TO BARNSON PTY LTD. NO PART OF THIS DRAWING MAY BE REPRODUCED IN ANY WAY WITHOUT THE WRITTEN PERMISSION OF BARNSON PTY LTD.

Rev	Date	Description
A	6-02-2024	PRELIMINARY DRAWING
B	18-03-2024	ISSUED FOR DA

Project
CIVIL DESIGN DOCUMENTATION
PROPOSED SUBDIVISION
Site Address
13 FAIRYDALE LANE
MUDGEE NSW 2850
Client
SANDERSON & MACDONALD PTY LTD

Drawing Title
PROPOSED SEWER PLAN

Design LM
Drawn JS
Check LM

Original Sheet Size
Revision

A1
B

Certification
Project No
Drawing No

37880
C08

BEDDING NOTES

1. THE MINIMUM DEPTH TO TOP OF PIPE SHALL BE 1000mm, EXCEPT UNDER ROAD PAVEMENT WHERE MINIMUM COVER TO TOP OF PIPE SHALL BE 1200mm MINIMUM UNLESS SHOWN OTHERWISE. PIPES WITH LESS COVER THAN THESE LIMITS TO BE CONCRETE ENCASED, AND DICL UNDER ROADS.
2. GRADES OF GRAVITY SEWER NOT TO BE FLATTER THAN 1:179 (0.55%) FOR 150mm DIAMETER PIPES AS PER WSA-2014.
3. MANHOLES SHALL BE PLACED AT EACH CHANGE IN DIRECTION OR GRADE OF THE PIPE LINE AT INTERVALS ALONG THE LINE NOT EXCEEDING 80m.

FIELD NOTES

1. BEARINGS AND DISTANCES ARE BY TITLE AND/OR DEED ONLY. NO BOUNDARY INVESTIGATION HAS BEEN CARRIED OUT.
2. SERVICES SHOWN HEREON HAVE BEEN DETERMINED FROM VISUAL EVIDENCE ONLY. PRIOR TO ANY DEMOLITION, EXCAVATION OR CONSTRUCTION ON THE SITE THE RELEVANT AUTHORITY SHOULD BE CONTACTED TO ESTABLISH DETAILED LOCATION AND DEPTH.
3. ALL HEIGHTS TO AHD (AUSTRALIAN HEIGHT DATUM).

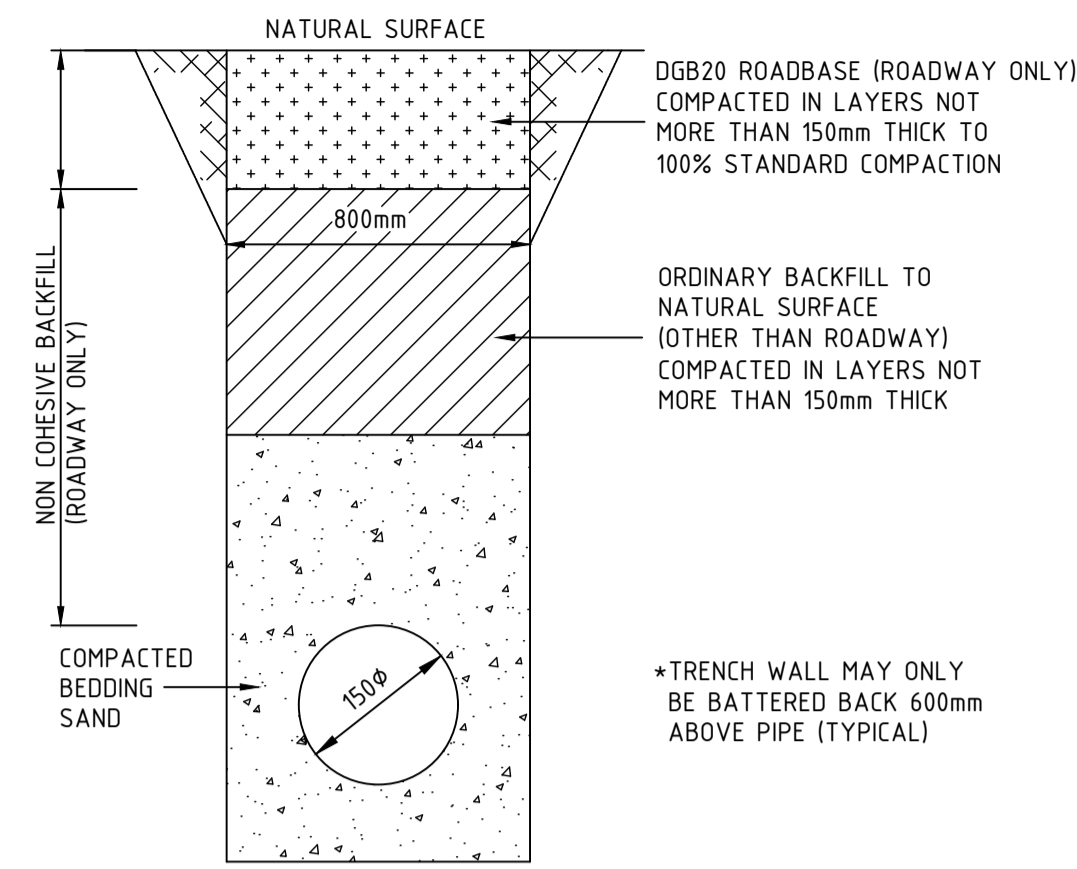

TYPICAL TRENCH SECTION
N.T.S.

* INSTALLATION OF UPVC PIPES SHALL TO CONFORM TO AS2032-1977 "INSTALLATION OF UPVC PIPE SYSTEMS", AS2566-1998 "BURIED FLEXIBLE PIPELINES", WSA-02 2002 AND MANUFACTURERS INSTRUCTIONS.

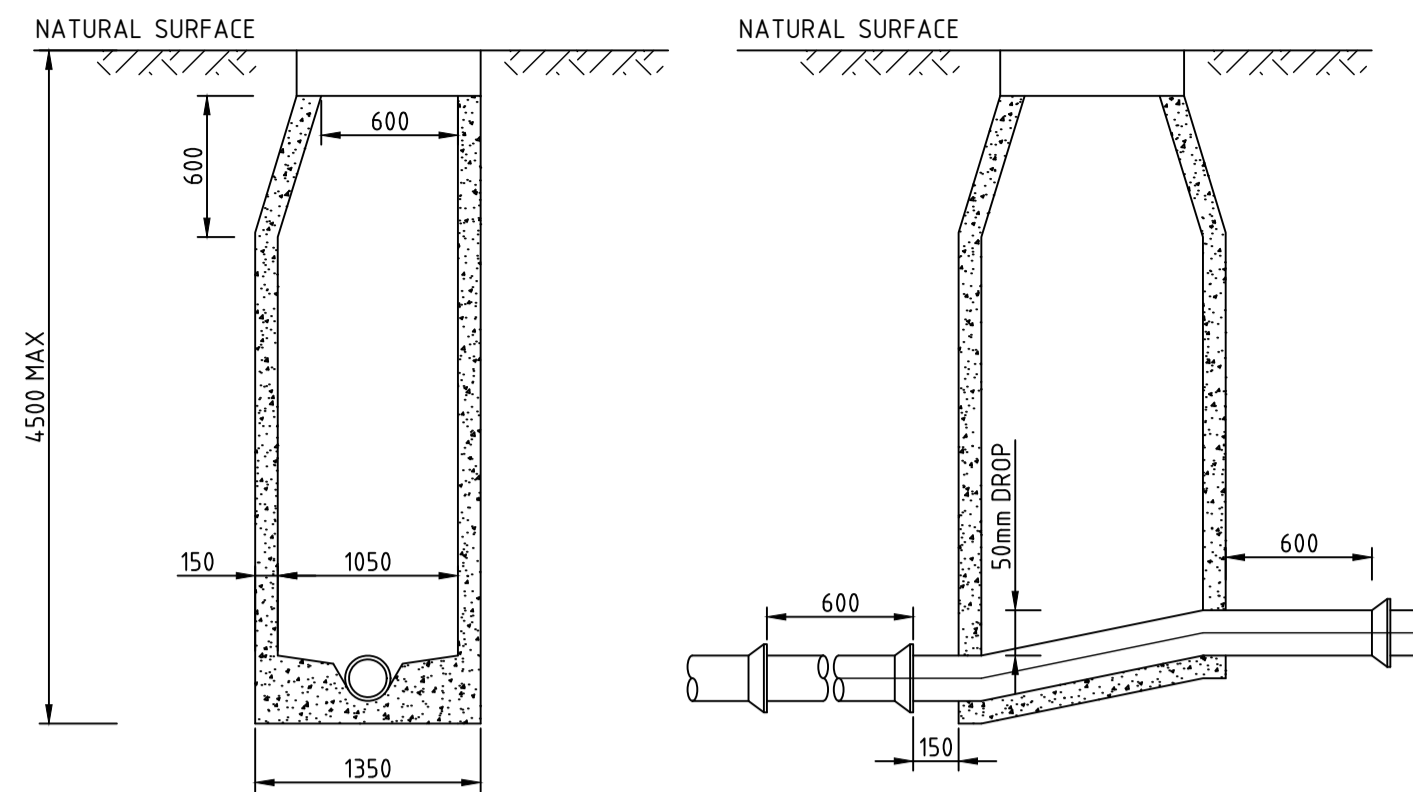

TYPICAL MANHOLE SECTION (150mmØ)
N.T.S.

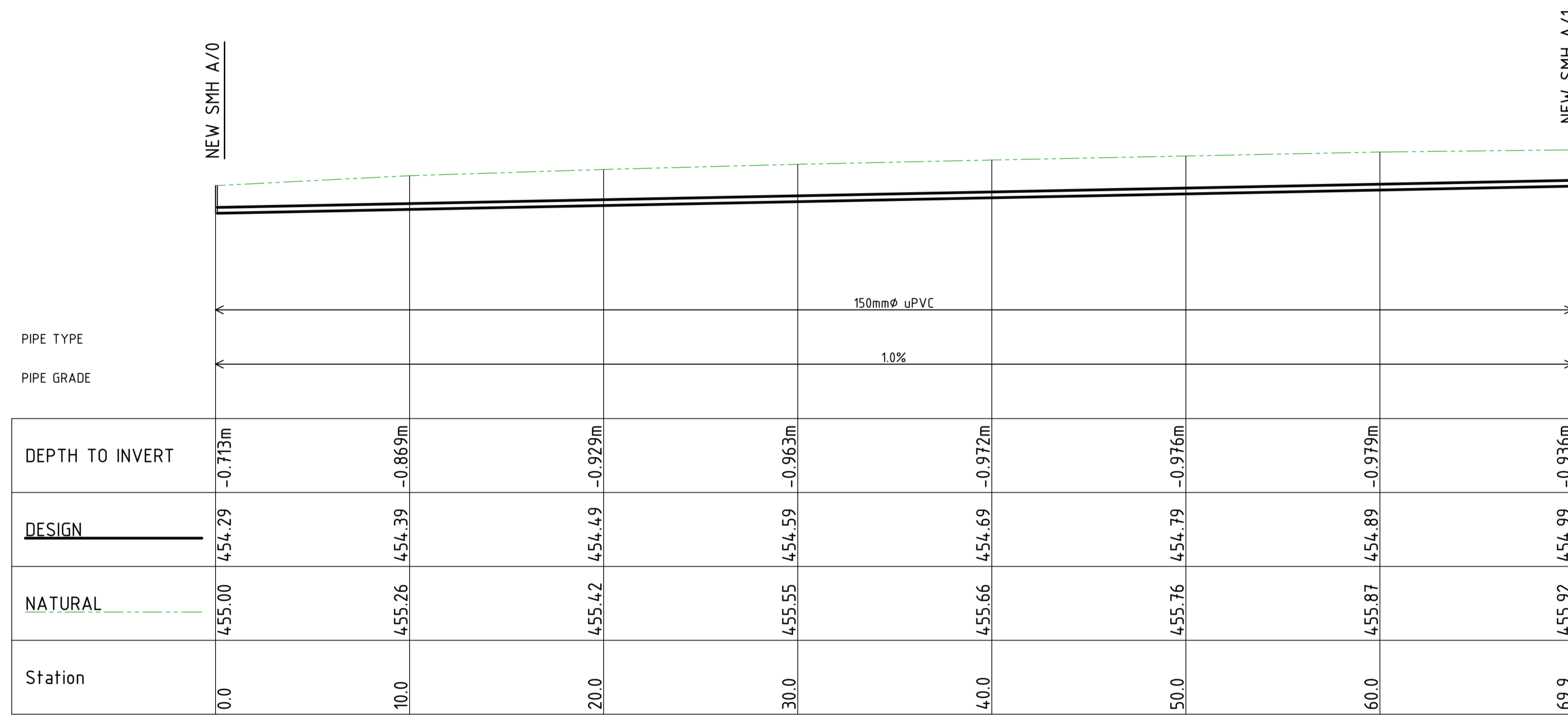

Scale Horizontal 1:200 Vertical 1:100

SEWER LONGSECTION

SUBMISSION FOR DA



LEGEND (existing)	
	EXISTING SUBJECT CADASTRAL BOUNDARIES
	EXISTING FENCE LINE
	EXISTING GATE
	EXISTING UNDERGROUND WATER MAIN - APPROX.
	EXISTING UNDERGROUND SEWER PIPE - COUNCIL DIAGRAM APPROX
	EXISTING UNDERGROUND ELECTRICITY CABLES - APPROX
	EXISTING OVERHEAD ELECTRICITY CABLES
	EXISTING UNDERGROUND TELECOMMUNICATIONS ASSETS- DBYD - APPROX.
	EXISTING TABLE DRAIN
	DRAIN PIPE INVERT ϕ 525mm
	EXISTING WATER METER
	ELECTRICITY POWER POLE
	WATER TAP
	FIRE HYDRANT
	WATER STOP VALVE
	SEWER MANHOLE
	GENERAL SIGN
	TELECOMMUNICATIONS PIT

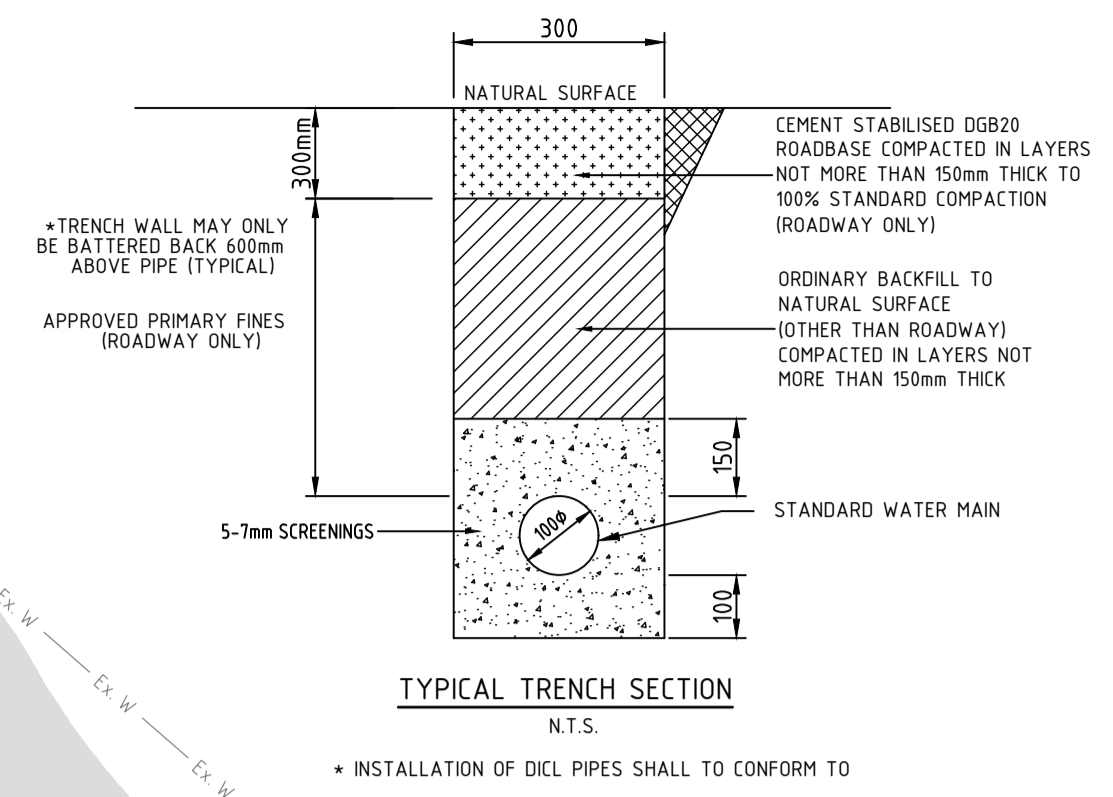

LEGEND (proposed)	
	PROPOSED CONCRETE
	PROPOSED BITUMEN
	PROPOSED KERB & GUTTER
	PROPOSED BOUNDARY
	PROPOSED EASEMENT BOUNDARY
	PROPOSED U/G STORMWATER DRAINAGE PIPE
	PROPOSED STORMWATER INLET PIT
	KERB INLET PIT
	PROPOSED U/G SEWER MAIN
	PROPOSED SEWER MANHOLE
	PROPOSED U/G WATER MAIN
	PROPOSED WATER METER
	PROPOSED WATER HYDRANT
	PROPOSED WATER STOP VALVE

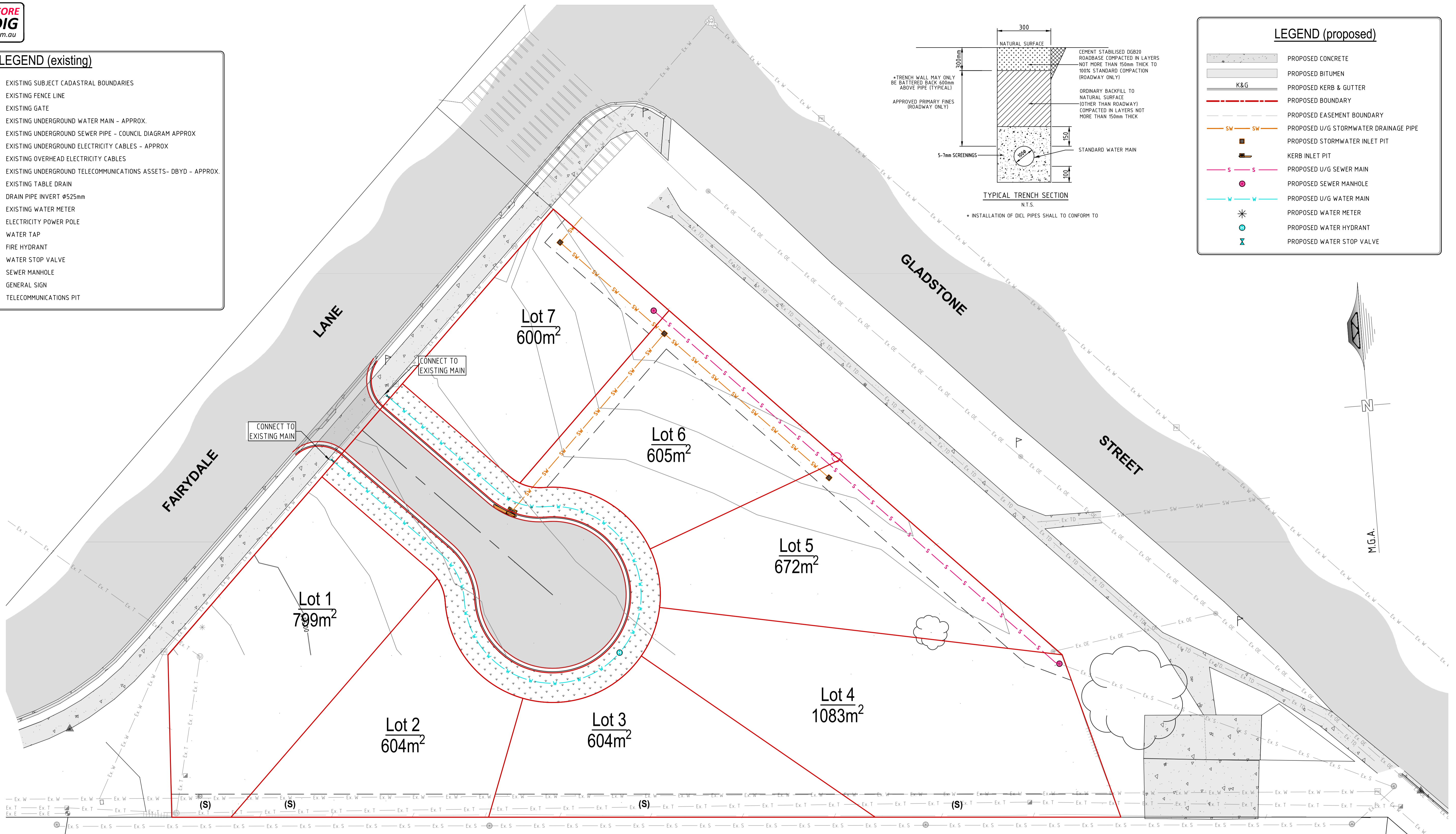

LOT 1
DP 999783

PROPOSED WATER PLAN
REDUCTION RATIO 1:250 @ A1
1:500 @ A3

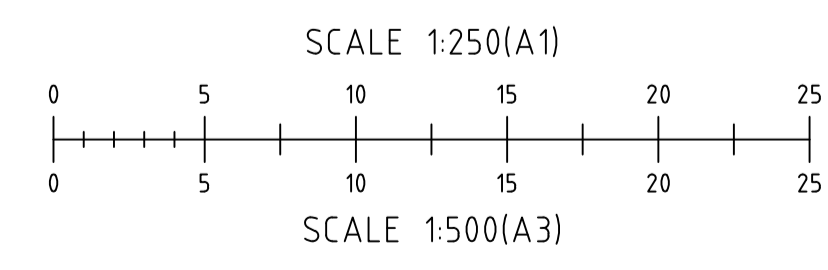

(S) EASEMENT FOR SERVICES 3 WIDE

SUBMISSION FOR DA



BARNSON PTY LTD

phone 1300 BARNSON (1300 227 676)
email generalenquiry@barnson.com.au
web barnson.com.au

THIS DRAWING IS TO BE READ IN CONJUNCTION WITH GENERAL BUILDING DRAWINGS, SPECIFICATIONS & OTHER CONSULTANTS DRAWINGS APPLICABLE TO THIS PROJECT. ALL DIMENSIONS IN MILLIMETRES. DO NOT SCALE. DIMENSIONS TO BE CHECKED ON SITE BEFORE COMMENCEMENT OF WORK. REPORT DISCREPANCIES TO BARNSON PTY LTD. NO PART OF THIS DRAWING MAY BE REPRODUCED IN ANY WAY WITHOUT THE WRITTEN PERMISSION OF BARNSON PTY LTD.

Rev	Date	Description
A	6-02-2024	PRELIMINARY DRAWING
B	18-03-2024	ISSUED FOR DA

Project
**CIVIL DESIGN DOCUMENTATION
PROPOSED SUBDIVISION**
Site Address
13 FAIRYDALE LANE
MUDGEE NSW 2850
Client
SANDERSON & MACDONALD PTY LTD

Drawing Title		Certification	
PROPOSED WATER PLAN		Project No 37880	
Design LM	Original Sheet Size A1	Drawing No C10	
Drawn JS	Revision B		
Check LM			