

STREET

ROBERTSON

LANE

HONEY

LOT 2  
DP 536954

LOT 1  
DP 536954

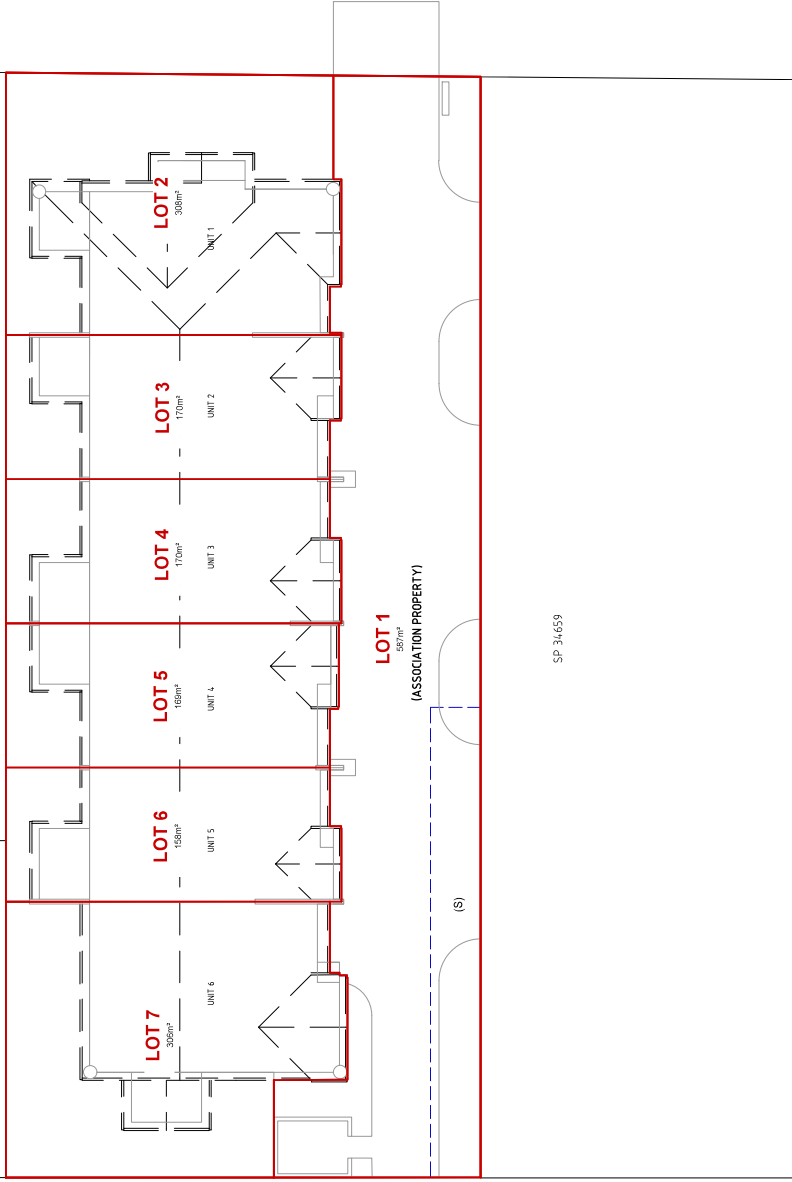

SP 34659

LOT 1  
SHOWN  
(ASSOCIATION PROPERTY)

PROPOSED COMMUNITY TITLE  
SUBDIVISION PLAN  
REDUCTION RATIO: 1:150 @ A1  
1:300 @ A3

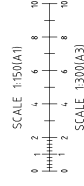

ISSUED TO CLIENT

- NOTES:**
- THIS PLAN WAS PREPARED BY BARNSON. THIS PLAN IS FOR USE OF COUNCIL AS PROPOSED SUBDIVISION OF LOT 12 IN DP 1282112 INTO LOTS & COMPANY PROPERTY. IN PARTICULAR, NO RELIANCE SHOULD BE PLACE ON THE INFORMATION ON THIS PLAN FOR ANY FINANCIAL, INVESTMENT OR LEGAL PURPOSES. THE LAND OTHER THAN AS TO ACCEPTOR, DEVELOPER, APPLICANT TO COUNCIL.
  - THIS PLAN HAS BEEN PREPARED PURSUANT TO THE DEED OF MUTUAL COVENANTS AND THE INSTRUMENTS OF TRANSFER AND THE INSTRUMENTS OF TRANSFER AND THE INSTRUMENTS OF TRANSFER AND THE INSTRUMENTS OF TRANSFER.
  - THIS PLAN DOES NOT REPRESENT AN APPROVED SUBMISSION BY COUNCIL UNTIL A COUNCIL STAMP APPEARS ON THIS PLAN WITH THE STATEMENT THAT DA APPROVAL HAS BEEN GRANTED.
  - THESE SERVICES SHOULD BE PRECISELY DETERMINED BY POTHOLES PRIOR TO DESIGN AND UNDERGROUND SERVICES THAT HAVE NOT BEEN SHOWN HEREIN, BARNSON TAKES NO RESPONSIBILITY FOR DAMAGE TO THESE SERVICES FROM DAMAGE TO THEM OR BE TAKEN TO OCCUPY DUE TO THE RELIANCE ON THIS PLAN FOR THE LOCATION OF UNDERGROUND SERVICES.

**BARNSON PTY LTD**  
 phone 1300 BARNSON (1300 227 670)  
 email generalenquiry@barnson.com.au  
 web barnson.com.au

Rev: A Date: 22.08.2024 Description: ISSUED TO CLIENT

Project: PROPOSED SUBDIVISION OF LOT 12 IN DP 1282112  
 30 ROBERTSON STREET  
 CHURCHILL NSW 2850  
 HAYES CONSTRUCTION PTY LTD

Drawn by: RB  
 Surveyed by: JS  
 Check by: RB  
 Original sheet size: A1  
 Revision: A

Certification:  
 Project No: 45513  
 Drawing No: L02