

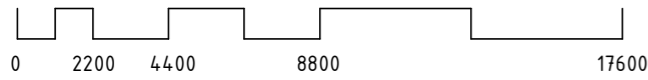



# 02 | SITE LAYOUT

SCALE: 1 : 220 (A3)



## LEGEND:

-  DENOTES BUILDERS ALLOCATED WASTE AREA DURING CONSTRUCTION
-  DENOTES SEDIMENT CONTROL BARRIER
-  DENOTES TEMPORARY GRAVEL CONSTRUCTION EXIT

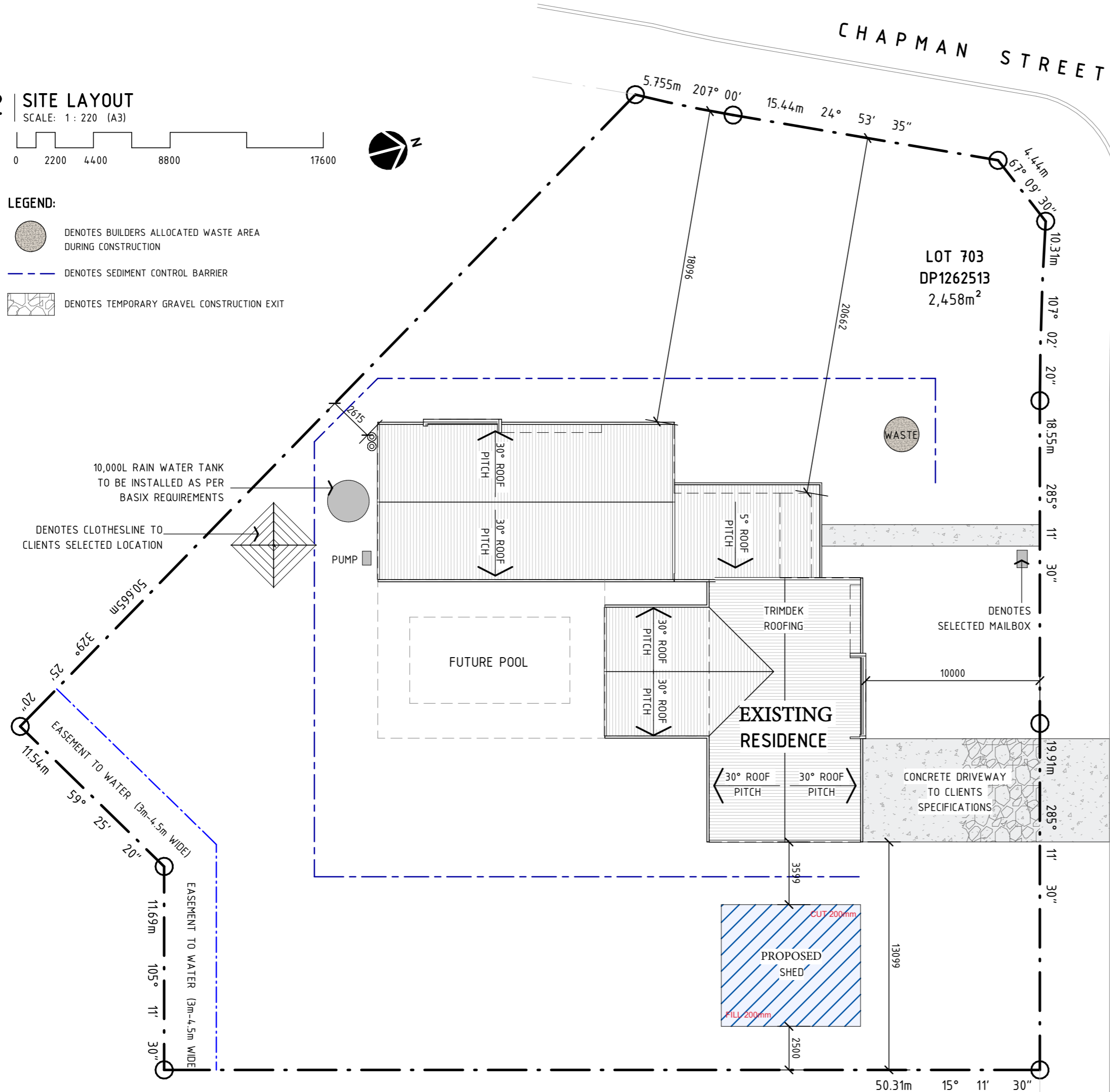

### CONTACT DETAILS

Gabrielle Hackett  
M. 0437 762 740  
E. gabrielle@onpointbuildingdesign.com.au  
A. 17 Church Street, Mudgee NSW 2850

THIS DRAWING IS AND ALWAYS SHALL REMAIN THE PROPERTY OF ON POINT BUILDING DESIGN AND MUST NOT BE LENT, GIVEN, SOLD, REPRODUCED OR VARIED IN ANY WAY WITHOUT WRITTEN CONSENT.  
ALL DIMENSIONS ARE IN MILLIMETRES. DO NOT SCALE. DIMENSIONS TO BE CHECKED ON SITE BEFORE COMMENCEMENT OF WORK.

Client:  
Project:  
**PROPOSED RESIDENCE AT 22 WEBSTER STREET, BOMBIRA**

Drawing Title:  
**SITE LAYOUT**

Rev	Date	Amendment
A	24/01/22	PRELIMINARY DRAWINGS
B	8/02/22	PRELIMINARY DRAWINGS
C	31/03/22	PRELIMINARY DRAWINGS
D	1/04/22	PRELIMINARY DRAWINGS
E	11/04/22	PRELIMINARY DRAWINGS
F	5/07/22	ISSUED FOR CLIENT REVIEW
G	27/07/22	ISSUED FOR APPROVAL



Job Number: 1294 - A02  
Revision: G

**ISSUED FOR APPROVAL**