

CASTLEREAGH HIGHWAY

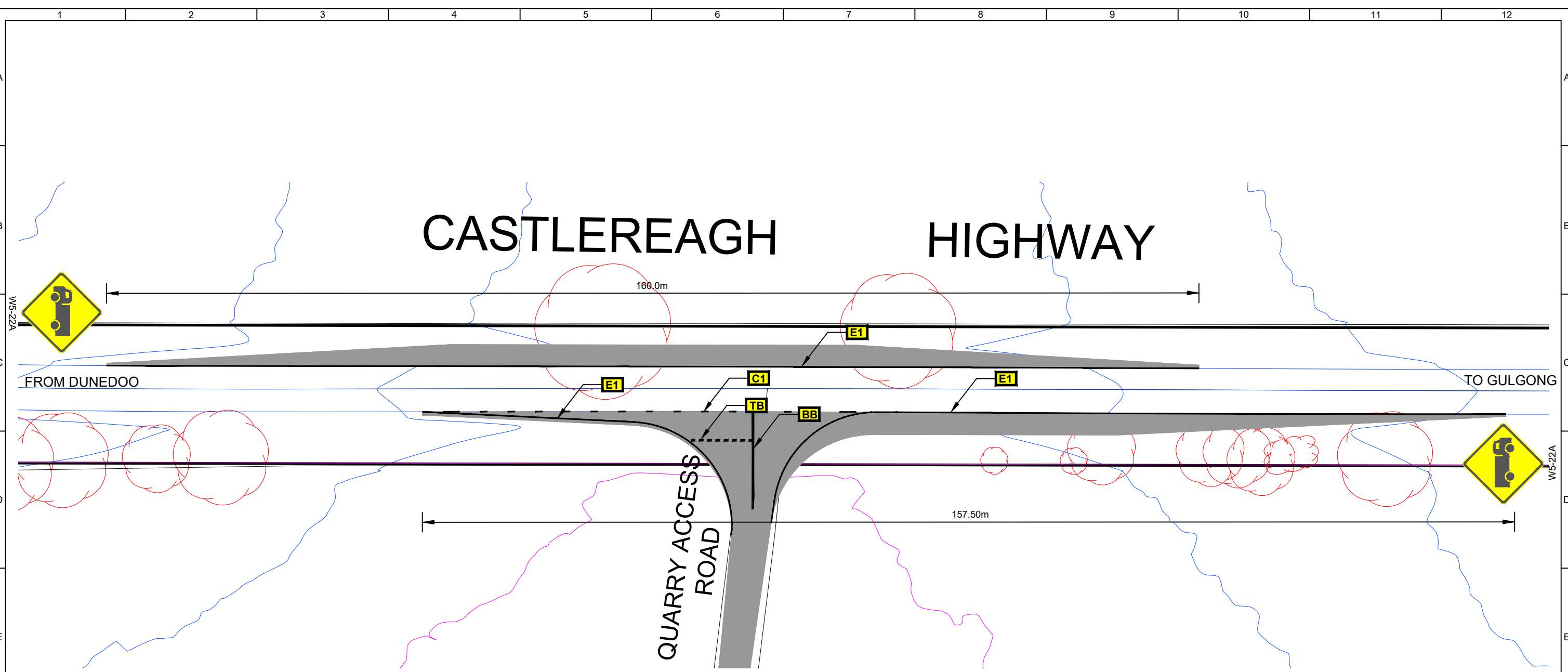

EXTENT OF SHOULDER WIDENING & BITUMEN SEAL



ISSUED FOR INFORMATION
23 July 2024

						 ABN - 45 604 145 315 PO BOX 1395 Port Macquarie NSW 2444 Mob:- 0412 009 558 or 0422 011 353 craig@streetwisersa.com.au or andy@streetwisersa.com.au	CLIENT	SCALE (A1)		PROJECT TITLE	PROPOSED GULGONG QUARRY OPERATION
								SCALE (A3)		DRAWING TITLE	CONCEPT DESIGN FOR QUARRY ACCESS WITH CASTLEREAGH HIGHWAY
								DATE	23-07-2024		
							DRAWN	C NETHERY			
							DESIGNED	C NETHERY			
							CHECKED				
							APPROVED				
A		ISSUED FOR INFORMATION		23-07-24	CAN				DRAWING No.	REV. A	
No.	REV. DESCRIPTION			DATE	DRAWN	CHECK.	ENG.	APP'D.			

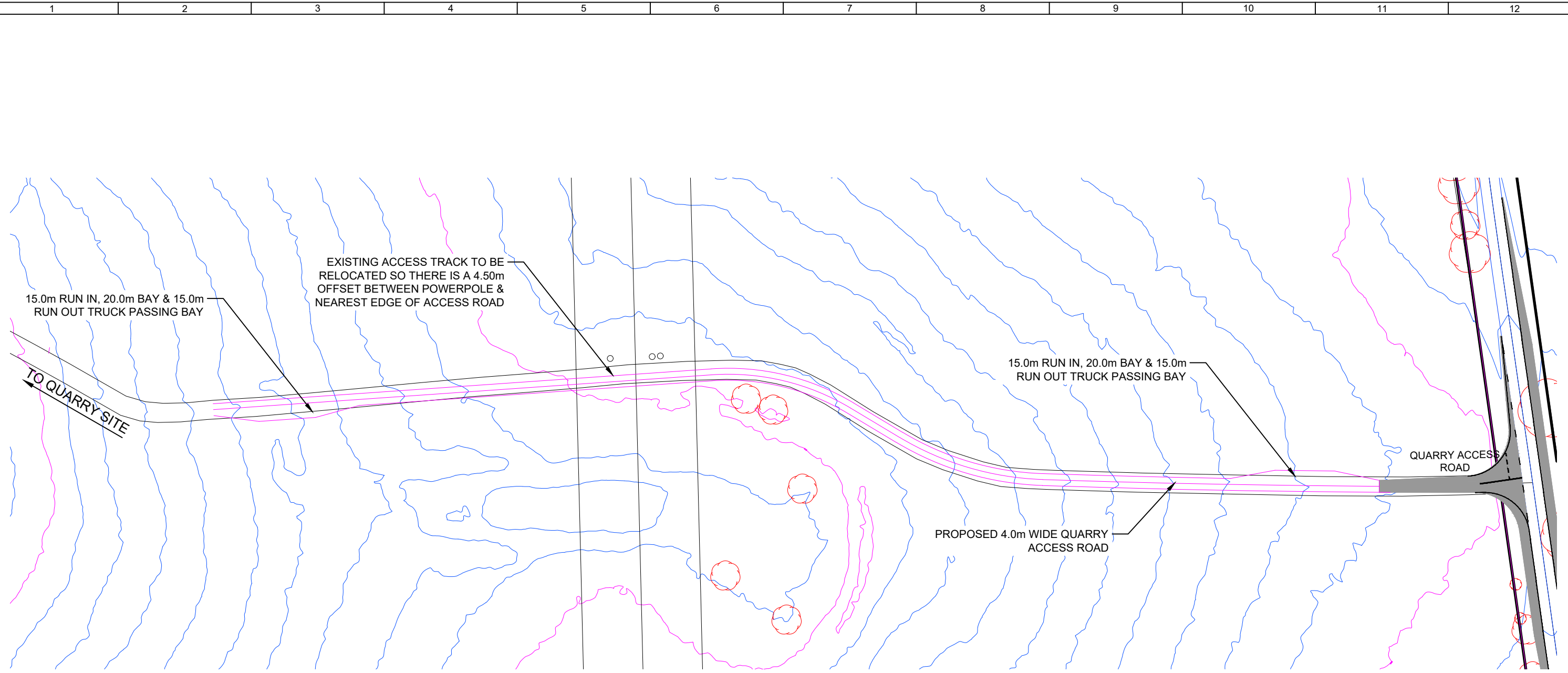

ISSUED FOR INFORMATION
23 July 2024

No.	REV. DESCRIPTION	DATE	DRAWN	CHECK.	ENG.	APP'D.
A	ISSUED FOR INFORMATION	23-07-24	CAN			



PO BOX 1395
Port Macquarie NSW 2444
Mob:- 0412 009 558 or 0422 011 353
craig@streetwisersa.com.au or
andy@streetwisersa.com.au

CLIENT	SCALE (A1)	
	SCALE (A3)	
	DATE	23-07-2024
	DRAWN	C NETHERY
	DESIGNED	C NETHERY
	CHECKED	
	APPROVED	

PROJECT TITLE	PROPOSED GULGONG QUARRY OPERATION
DRAWING TITLE	CONCEPT DESIGN FOR INTERNAL QUARRY ACCESS ROAD
DRAWING No.	REV. A